

discharge on then central panel

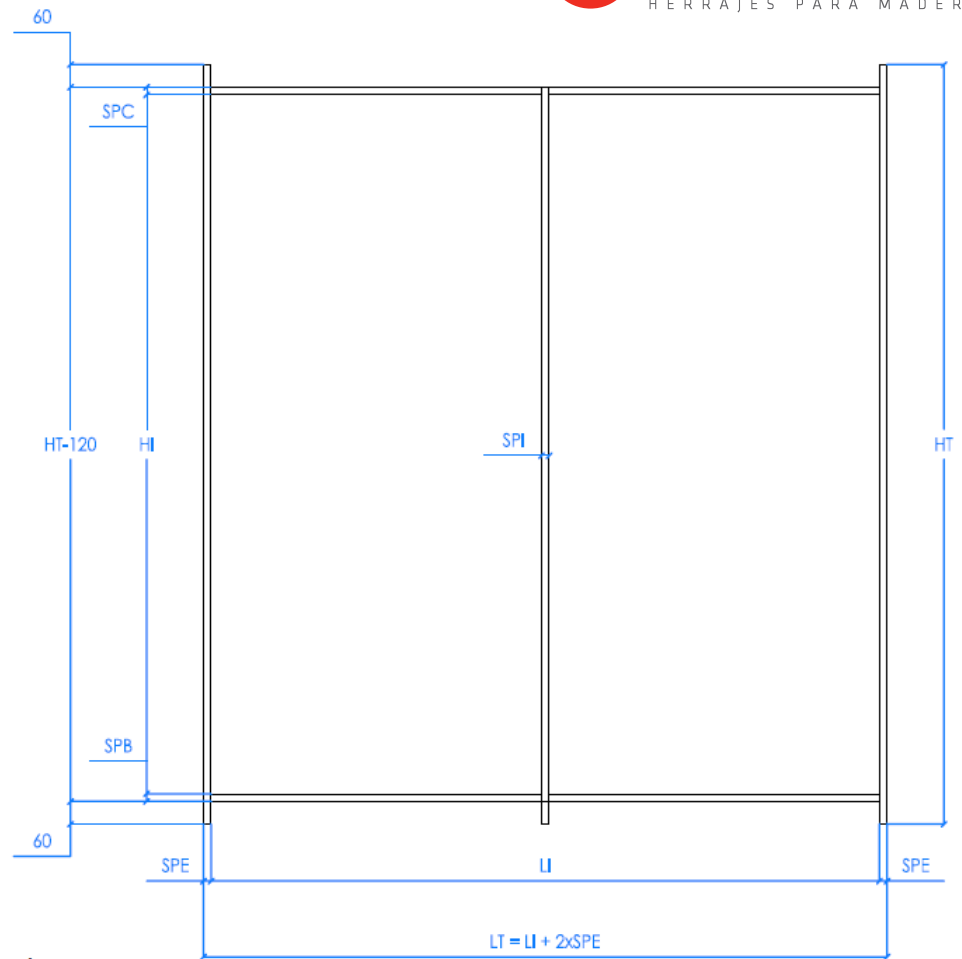

SAE≤25

Internal Adjusters

F = 218,15
G = 24,15

External Adjusters

F = 229,15
G = 35,15

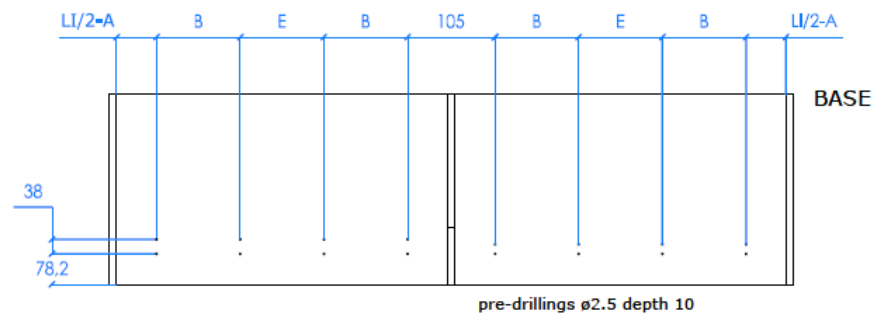
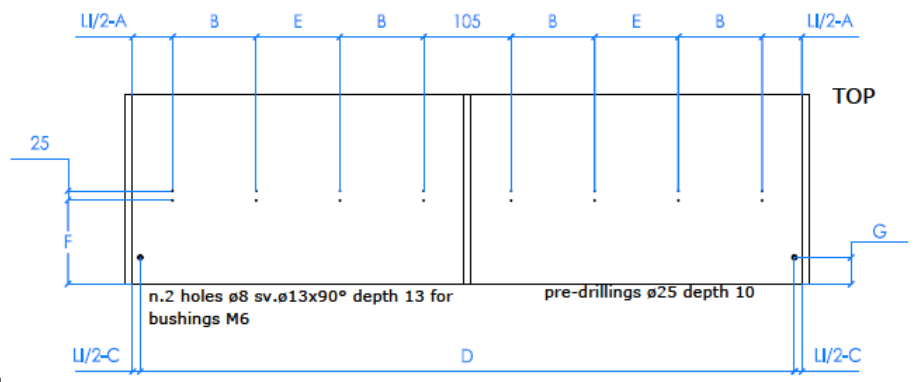

LI	A	B	C	D	E	N° CLIP
1200-1299	560	0	583,5	1167	507,5	4
1300-1399	610	0	633,5	1267	557,5	4
1400-1499	660	303,75	683,5	1367	0	6
1500-1599	710	328,75	733,5	1467	0	6
1600-1799	760	353,75	783,5	1567	0	6
1800-1999	860	403,75	883,5	1767	0	6
2000-2199	960	453,75	983,5	1967	0	6
2200-2399	1060	503,75	1083,5	2167	0	6
2400-2599	1160	553,75	1183,5	2367	0	6
2600-2799	1260	402	1283,5	2567	403,5	8
2800-2999	1360	435	1383,5	2767	437,5	8
3000-3199	1460	469	1483,5	2967	469,5	8
3200-3399	1560	502	1583,5	3167	503,5	8
3400-3599	1660	535	1683,5	3367	537,5	8
3600-3799	1760	569	1783,5	3567	569,5	8
3800-3999	1860	602	1883,5	3767	603,5	8



Description : Workings on the structure M50+

Scale : Out of scale

Date :

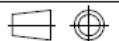

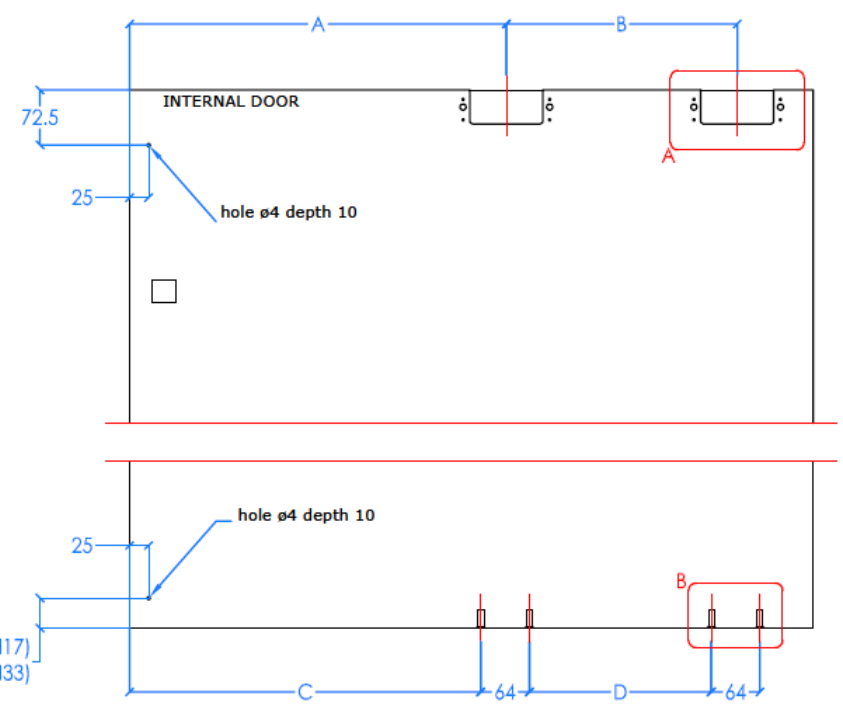
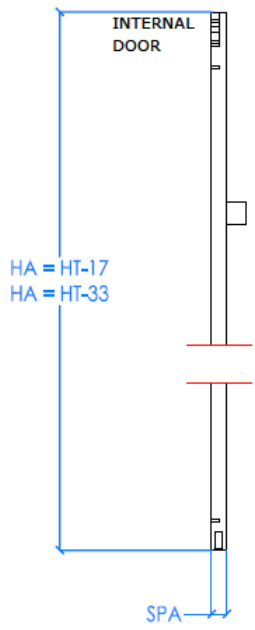

U	A	B	C	D
1200-1299	344	179	310.4	101.6
1300-1399	369	204	335.4	126.6
1400-1499	394	204	360.4	151.6
1500-1599	419	254	385.4	176.6
1600-1799	444	254	410.4	176.6
1800-1999	494	304	460.4	226.6
2000-2199	544	354	510.4	276.6
2200-2399	594	404	560.4	326.6
2400-2599	644	454	610.4	376.6
2600-2799	694	504	660.4	426.6
2800-2999	744	554	710.4	476.6
3000-3199	794	604	760.4	526.6
3200-3399	844	654	810.4	576.6
3400-3599	894	704	860.4	626.6
3600-3799	944	754	910.4	676.6
3800-3999	994	804	960.4	726.6

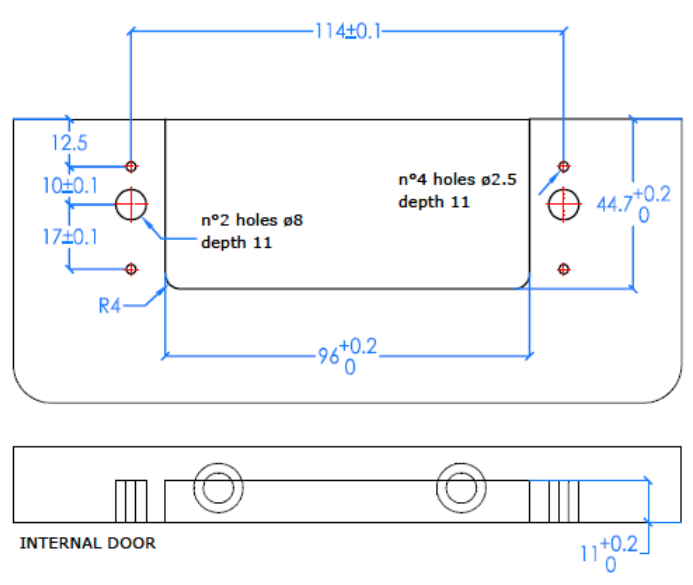
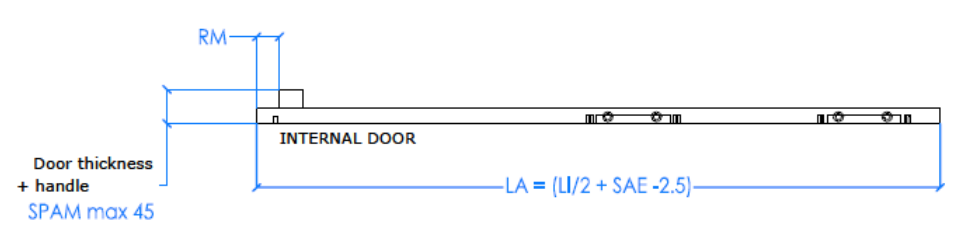

DETAIL A
SCALE 1:2
Workings detail for upper adjusters

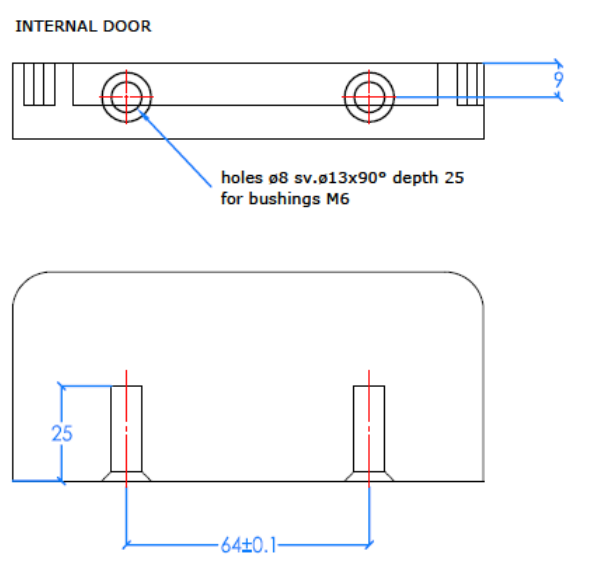

DETAIL B
SCALE 1: 2
Workings detail for lower carriages



Description : Workings for the left wooden M50+ with internal adjusters

Scale : Out of scale

Date :

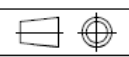

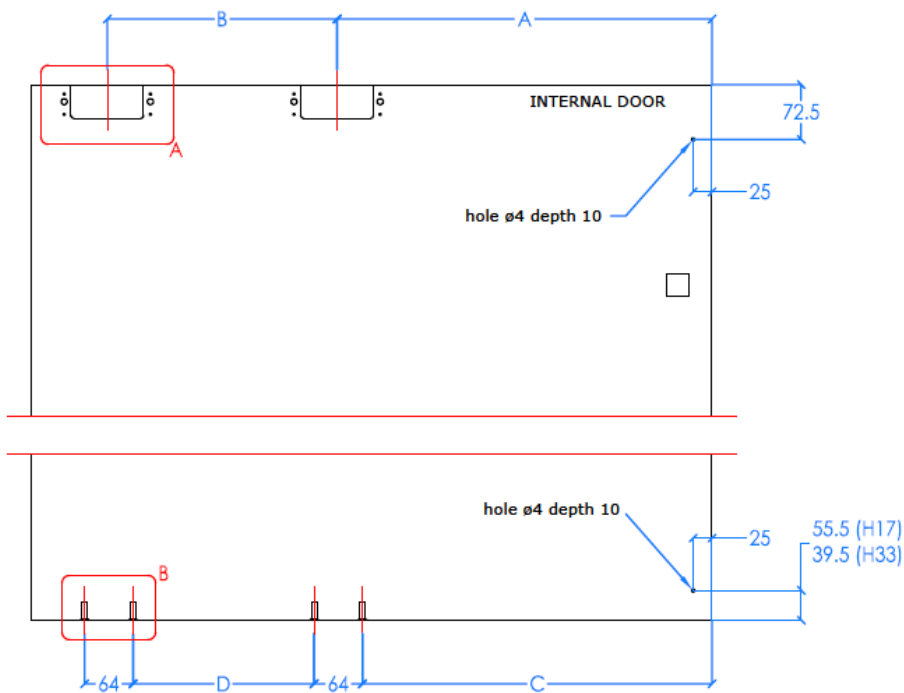
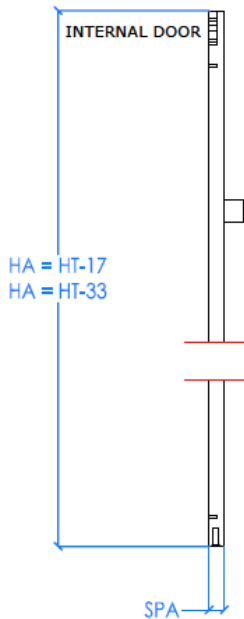

L	A	B	C	D
1200-1299	344	179	310.4	101.6
1300-1399	369	204	335.4	126.6
1400-1499	394	204	360.4	151.6
1500-1599	419	254	385.4	176.6
1600-1799	444	254	410.4	176.6
1800-1999	494	304	460.4	226.6
2000-2199	544	354	510.4	276.6
2200-2399	594	404	560.4	326.6
2400-2599	644	454	610.4	376.6
2600-2799	694	504	660.4	426.6
2800-2999	744	554	710.4	476.6
3000-3199	794	604	760.4	526.6
3200-3399	844	654	810.4	576.6
3400-3599	894	704	860.4	626.6
3600-3799	944	754	910.4	676.6
3800-3999	994	804	960.4	726.6

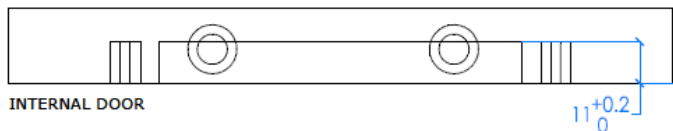
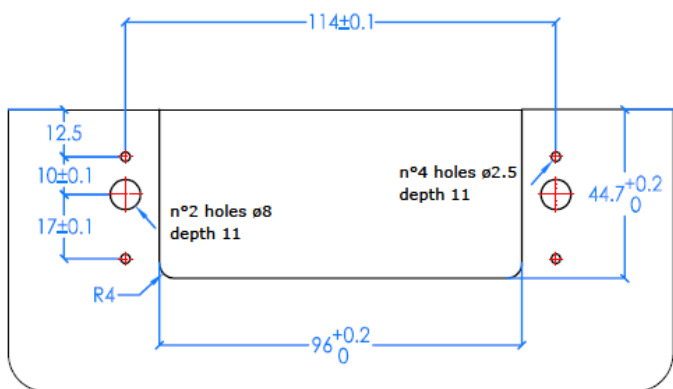
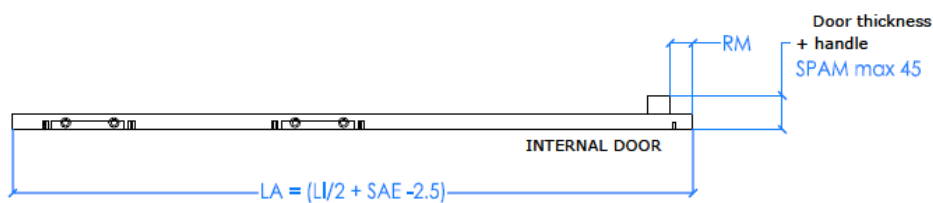

DETAIL A
SCALE 1:2
Workings detail for upper adjusters

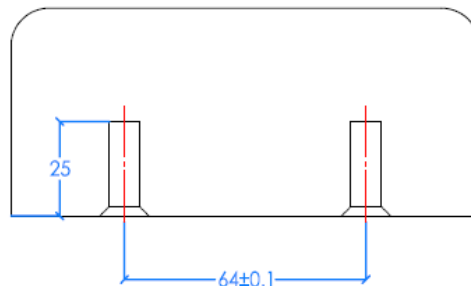
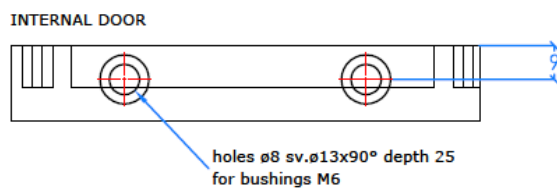

DETAIL B
SCALE 1: 2
Workings detail for lower carriages



Description : Workings for the right wooden M50+ with internal adjusters

Scale : Out of scale

Date :

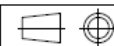

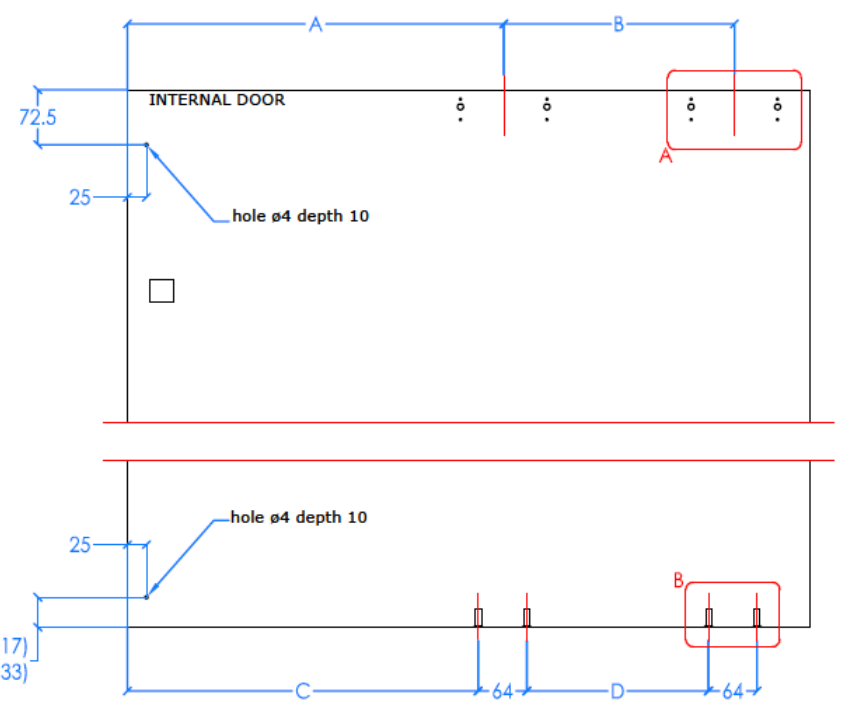
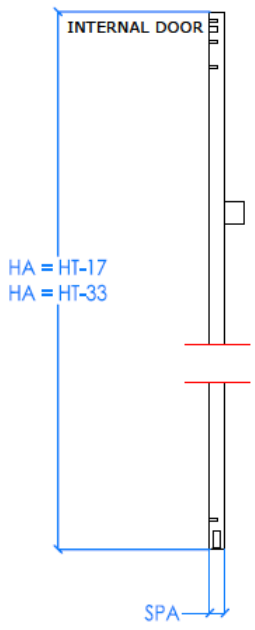

L	A	B	C	D
1200-1299	344	179	310.4	101.6
1300-1399	369	204	335.4	126.6
1400-1499	394	204	360.4	151.6
1500-1599	419	254	385.4	176.6
1600-1799	444	254	410.4	176.6
1800-1999	494	304	460.4	226.6
2000-2199	544	354	510.4	276.6
2200-2399	594	404	560.4	326.6
2400-2599	644	454	610.4	376.6
2600-2799	694	504	660.4	426.6
2800-2999	744	554	710.4	476.6
3000-3199	794	604	760.4	526.6
3200-3399	844	654	810.4	576.6
3400-3599	894	704	860.4	626.6
3600-3799	944	754	910.4	676.6
3800-3999	994	804	960.4	726.6

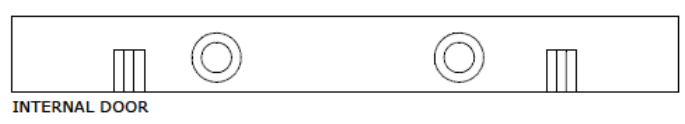
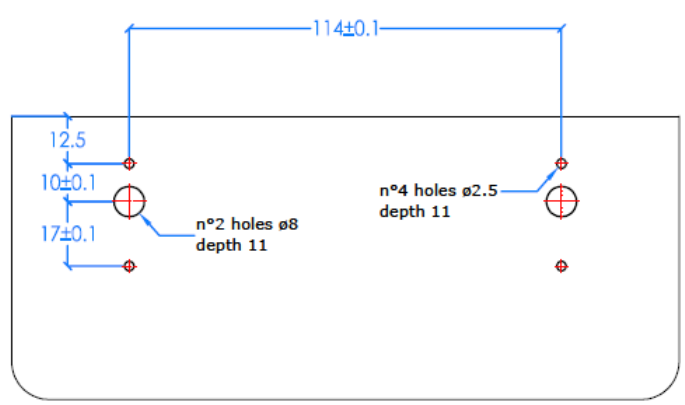
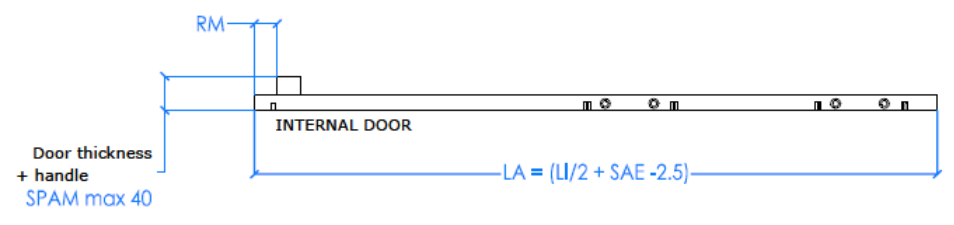

DETAIL A
SCALE 1:2
Workings detail for upper adjusters

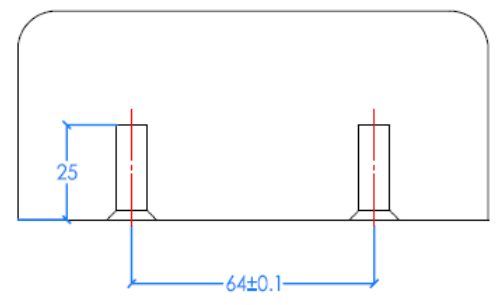
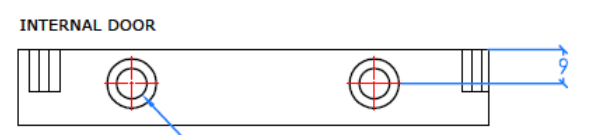

DETAIL B
SCALE 1:2
Workings detail for lower carriages



Description : Workings for the left wooden M50+ with external adjusters

Scale : Out of scale

Date :

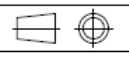

HA = HT-17
HA = HT-33

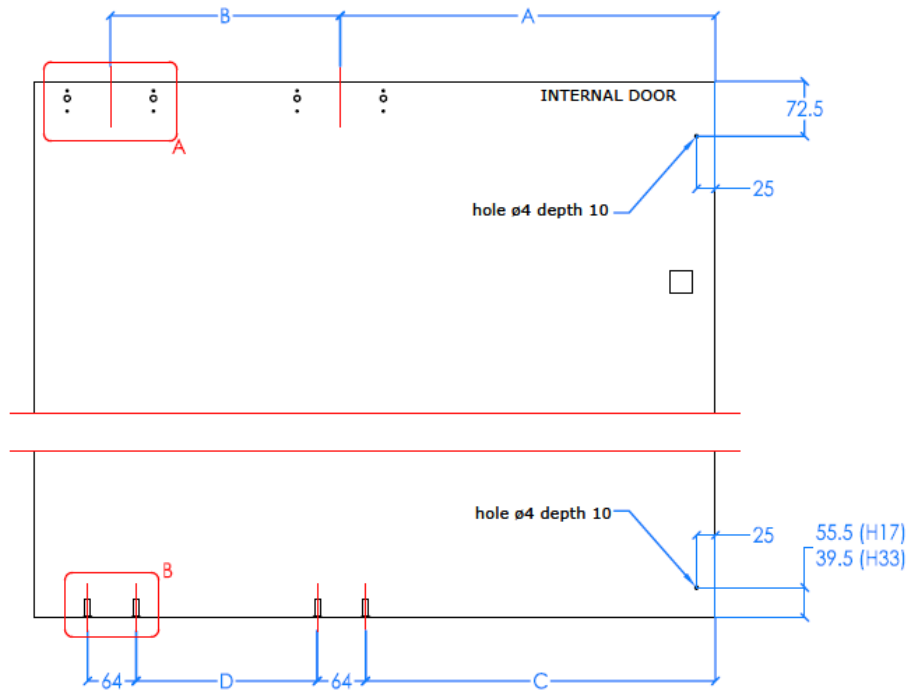
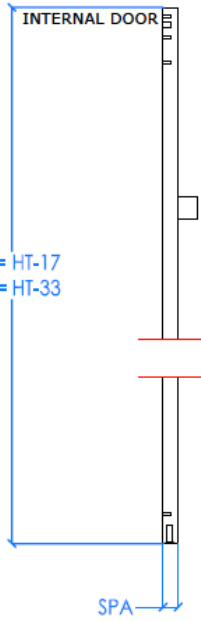

U	A	B	C	D
1200-1299	344	179	310.4	101.6
1300-1399	369	204	335.4	126.6
1400-1499	394	204	360.4	151.6
1500-1599	419	254	385.4	176.6
1600-1799	444	254	410.4	176.6
1800-1999	494	304	460.4	226.6
2000-2199	544	354	510.4	276.6
2200-2399	594	404	560.4	326.6
2400-2599	644	454	610.4	376.6
2600-2799	694	504	660.4	426.6
2800-2999	744	554	710.4	476.6
3000-3199	794	604	760.4	526.6
3200-3399	844	654	810.4	576.6
3400-3599	894	704	860.4	626.6
3600-3799	944	754	910.4	676.6
3800-3999	994	804	960.4	726.6

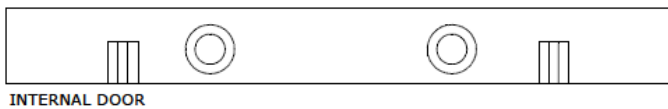
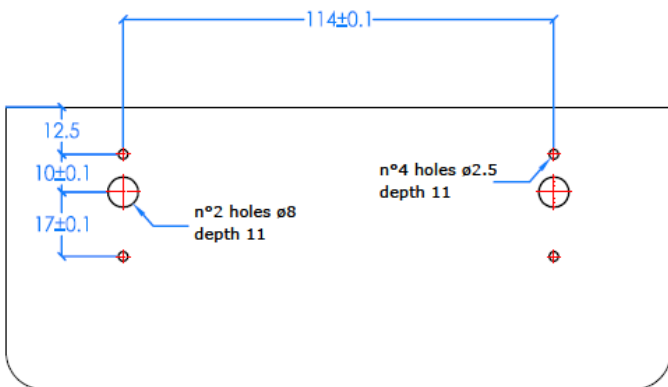
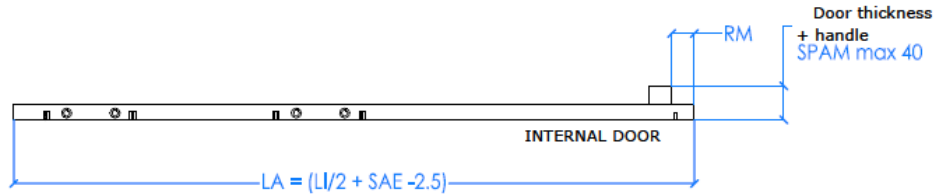

DETAIL A
SCALE 1:2
Workings detail for upper adjusters



holes ø8 sv. ø13x90° depth 25
for bushings M6

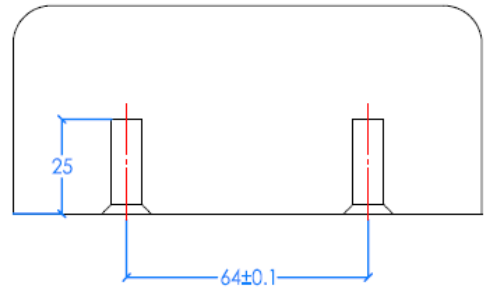

DETAIL B
SCALE 1: 2
Workings detail for lower carriages



Description : Workings for the right wooden M50+ with external adjusters

Scale : Out of scale

Date :



