

x2

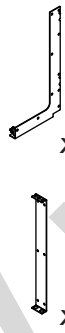

x1



x1

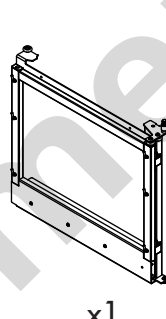

x1

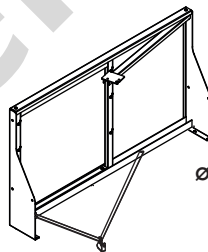

x1



P0

x1

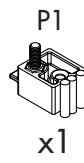

P1

x1



P2

x1



P3

x1

ø4x30 mm



x1

M5x16 mm



x1

M5



x1

ø4x16 mm



x22

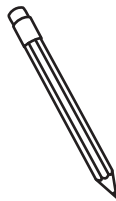
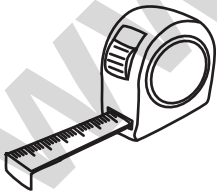

3 / 5

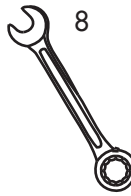

8

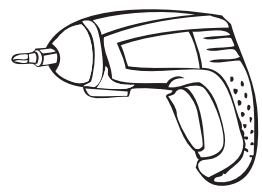
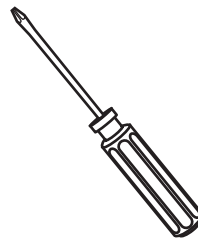

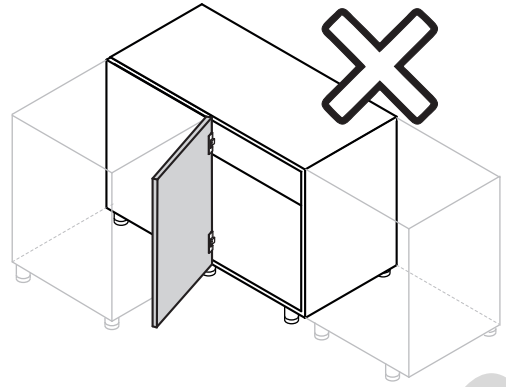
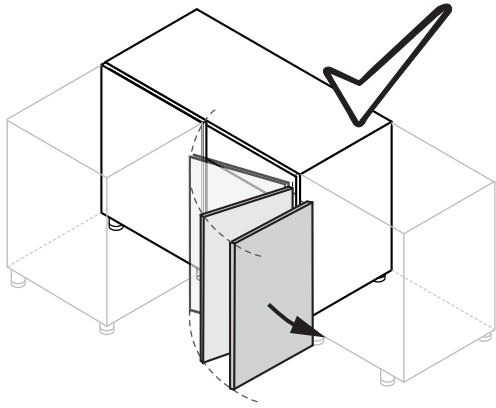

1

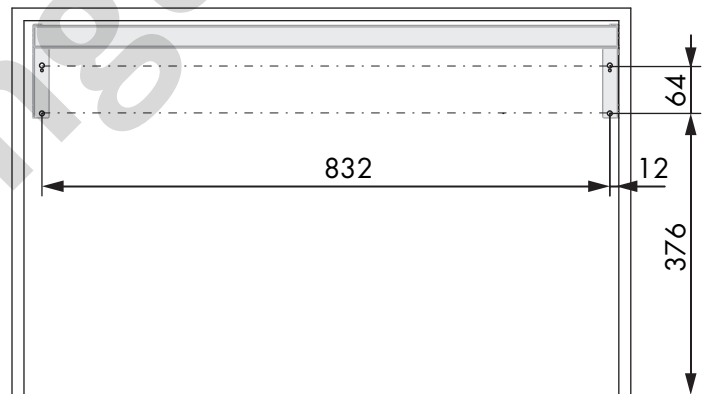
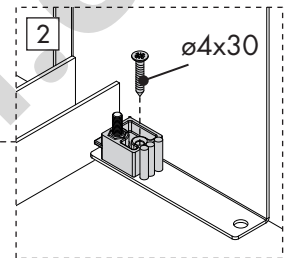
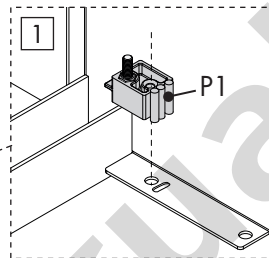
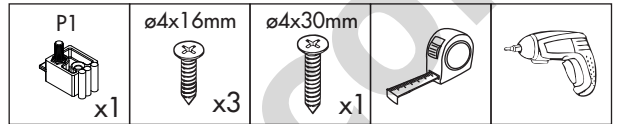
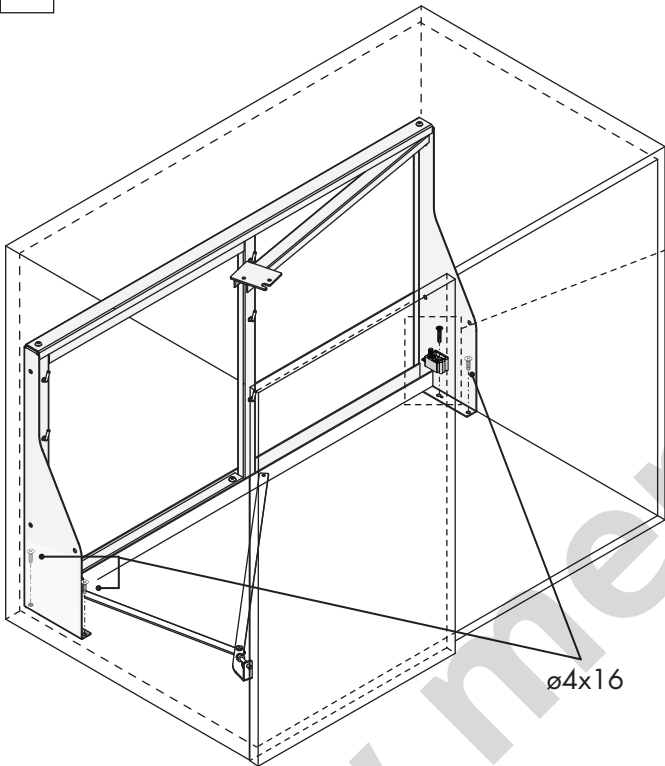

Unidades en milímetros | Units in millimeters | Unités en millimètres

2

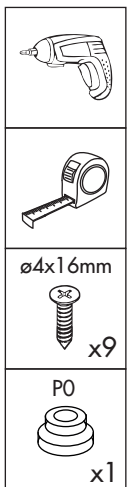
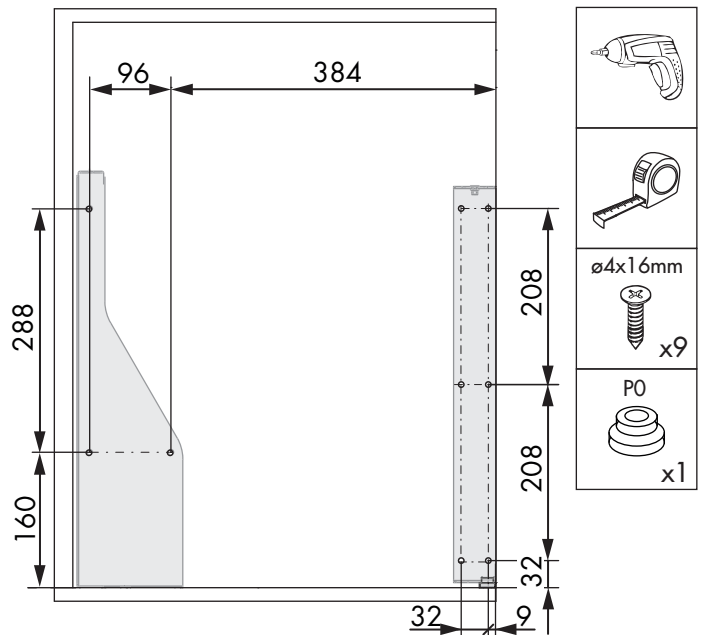
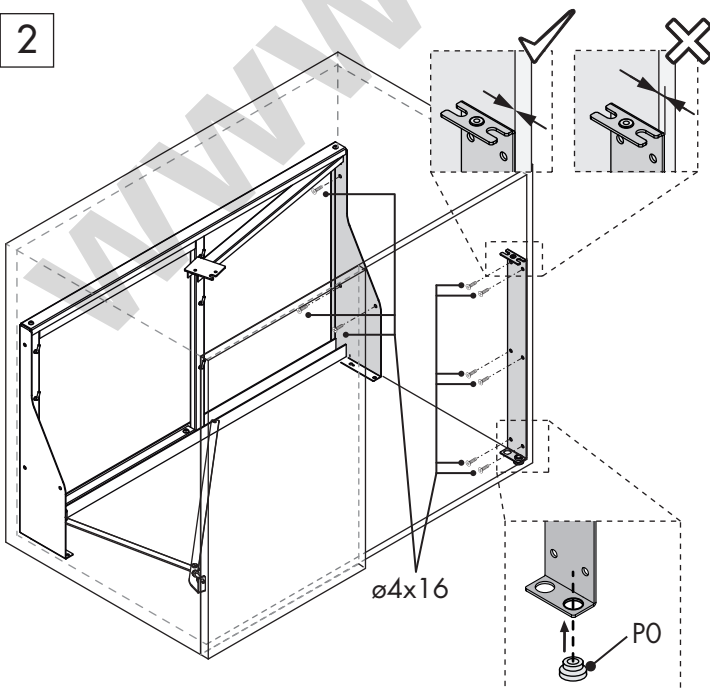

Unidades en milímetros | Units in millimeters | Unités en millimètres

3

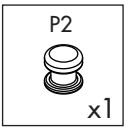
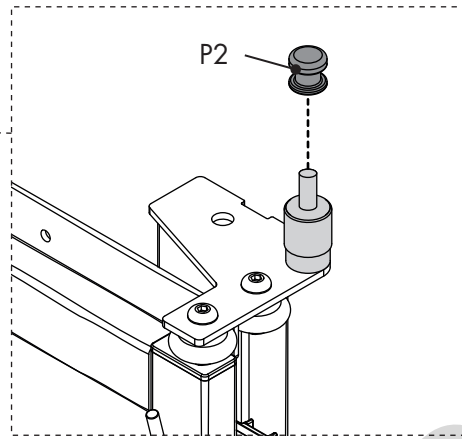
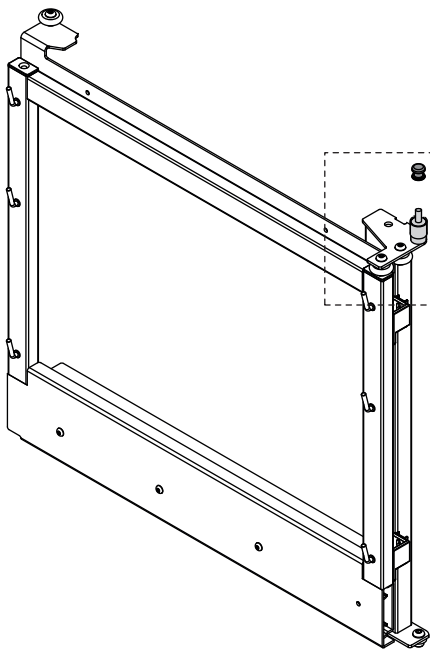

4

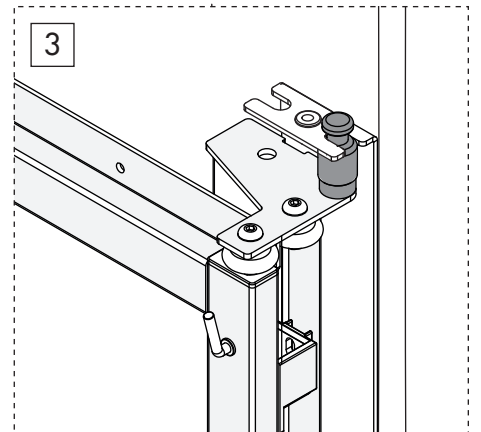
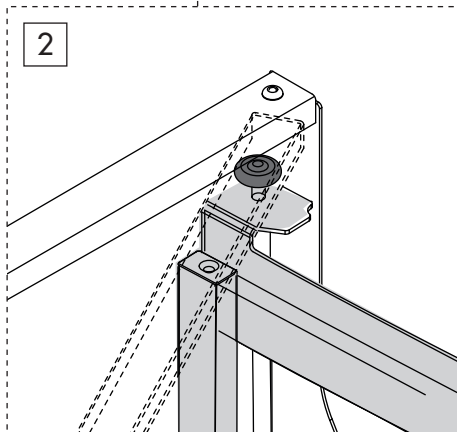
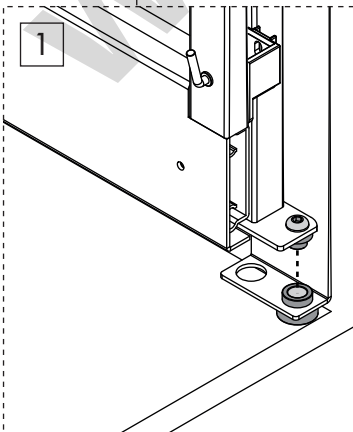
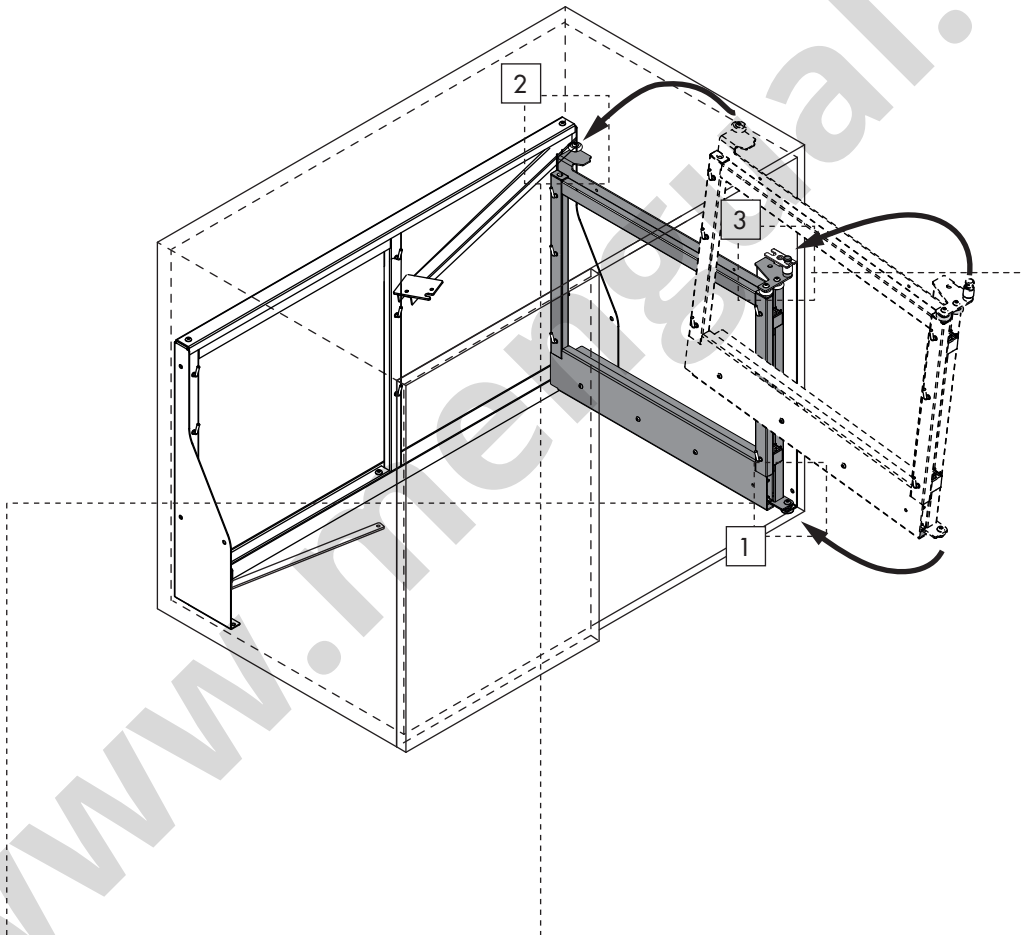

5

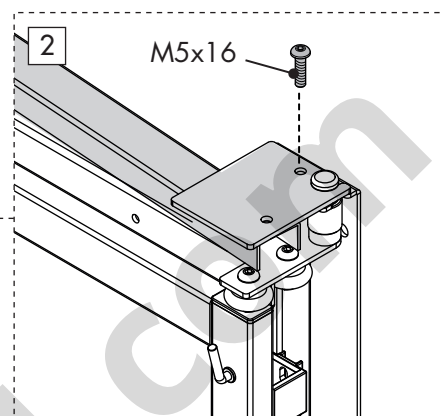
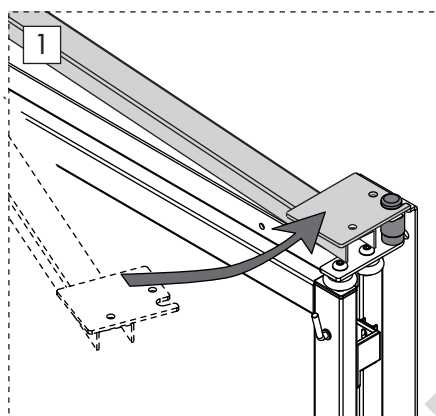
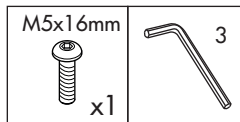
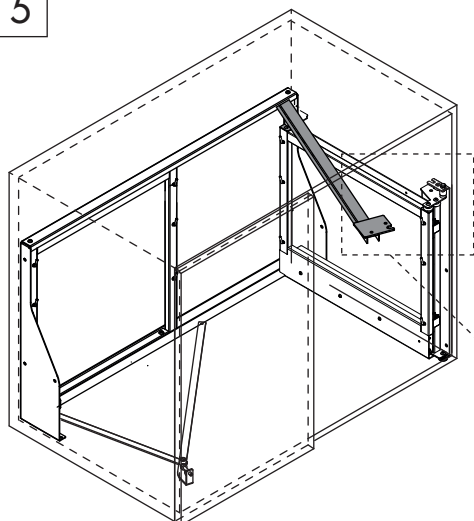

6

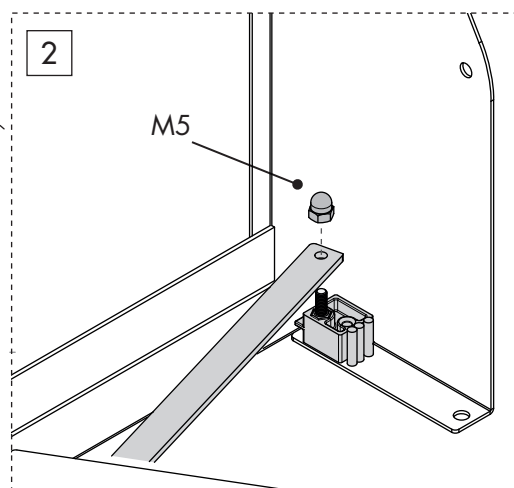
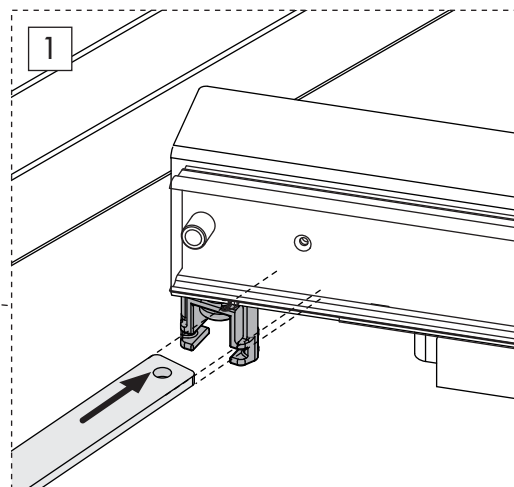
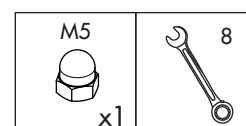
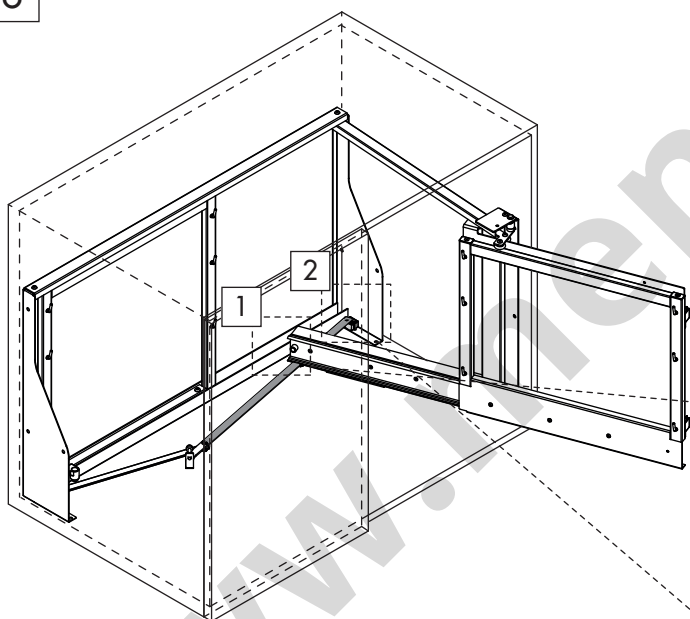

Respetar orden de montaje. No hacerlo puede implicar la rotura de la pieza de plástico (M5).  
 Respect assembly steps order. Not doing so can cause the breaking of the plastic piece (M5).  
 Respecter l'ordre de montage. Ne pas le faire peut provoquer la rupture de la pièce en plastique (M5).

7

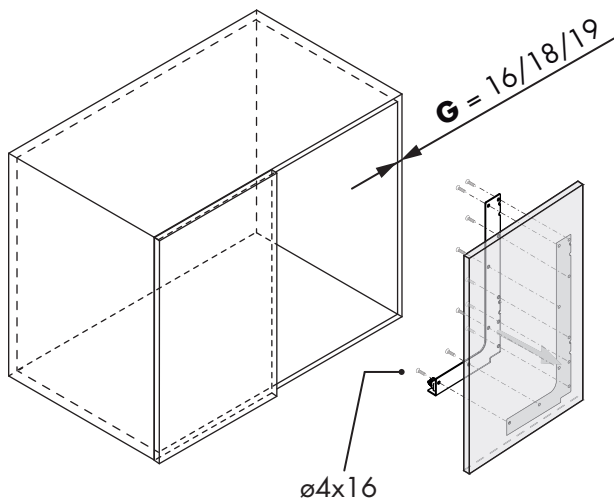

ø4x16

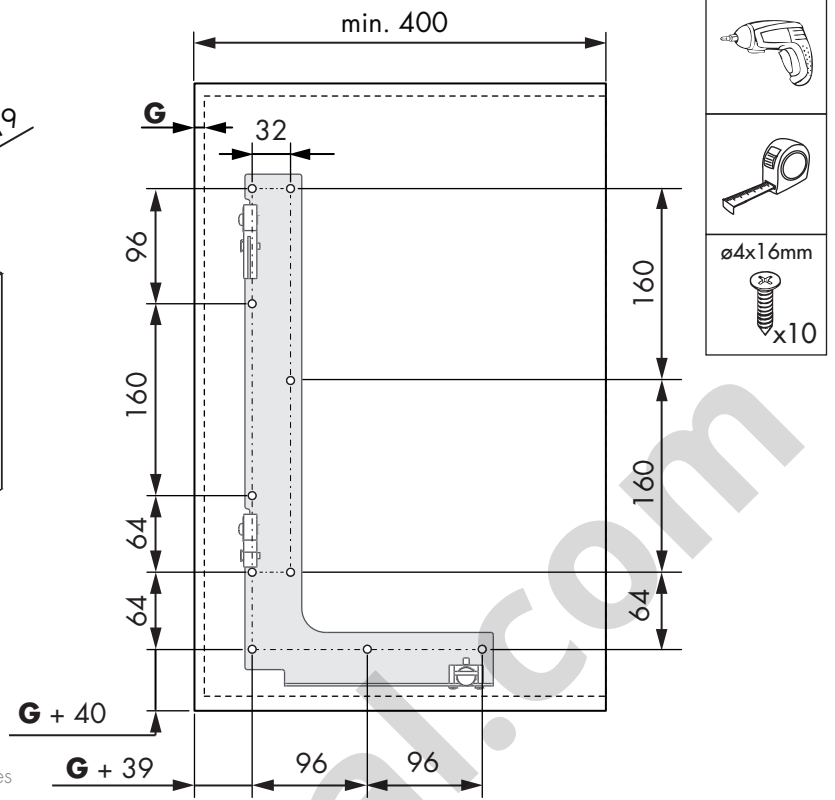

G : Grosor mueble | Cabinet thickness | Grosseur du meuble  
 Unidades en milímetros | Units in millimeters | Unités en millimètres

8

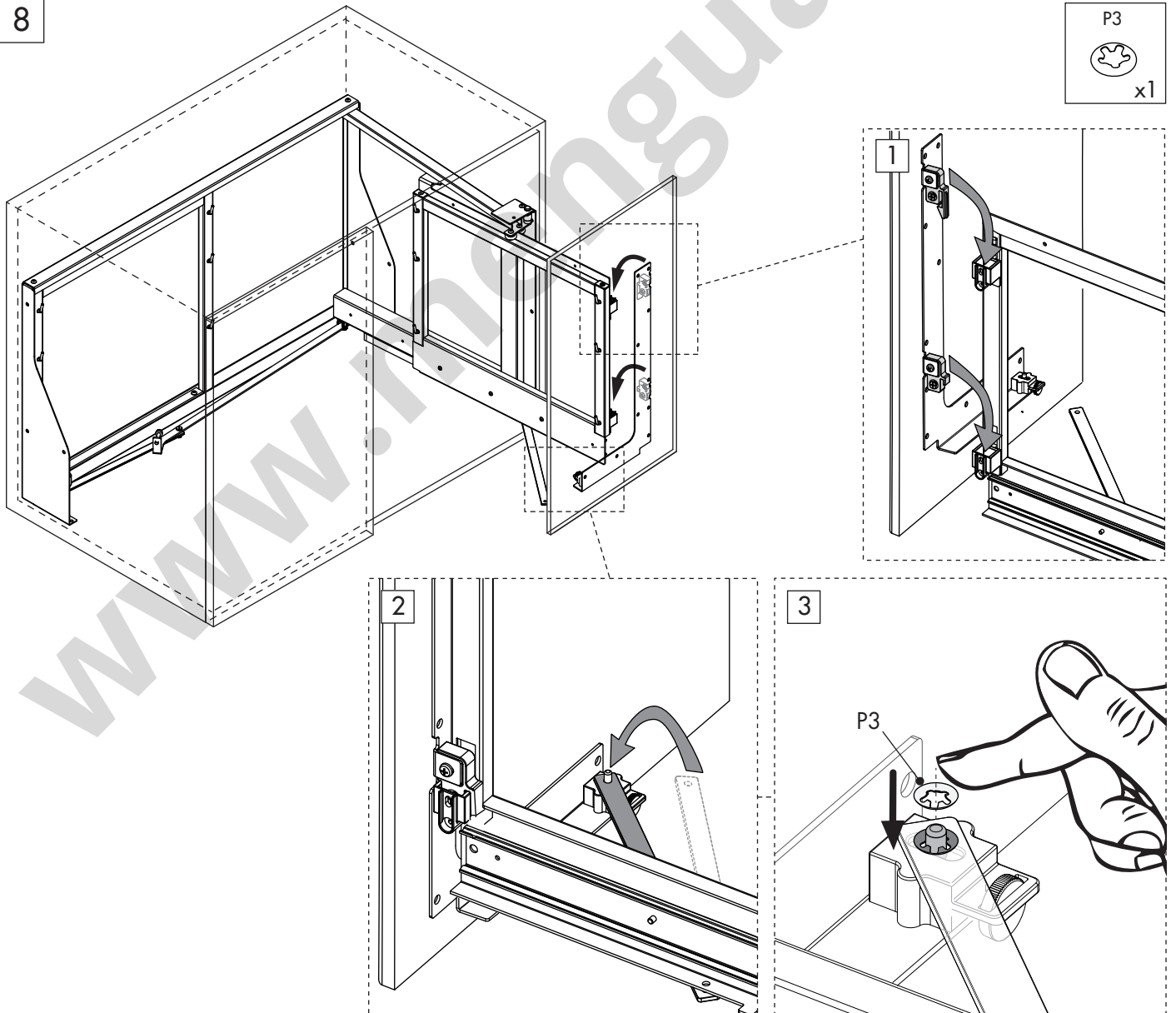

P3

x1

9

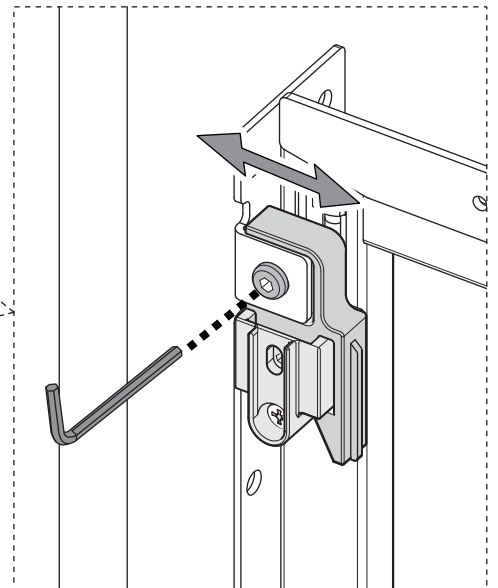
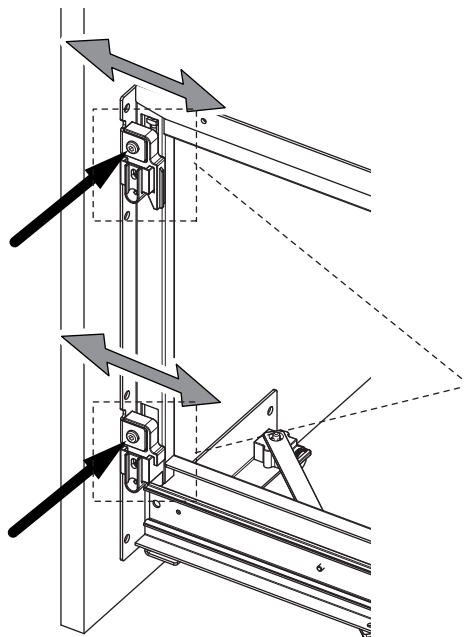
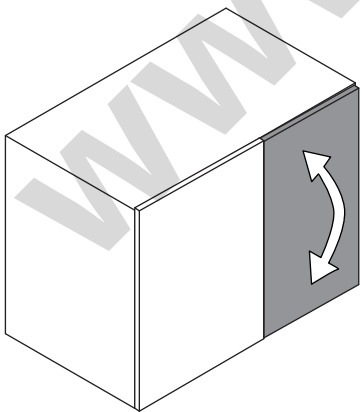
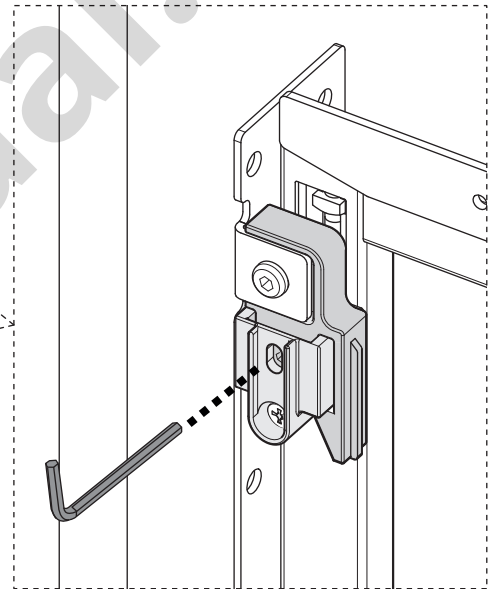
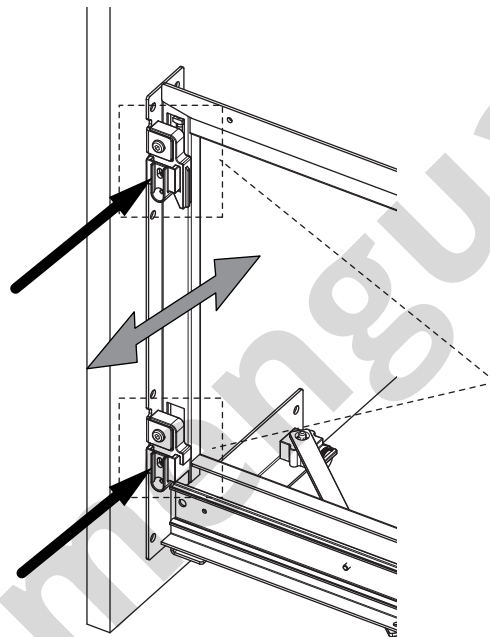
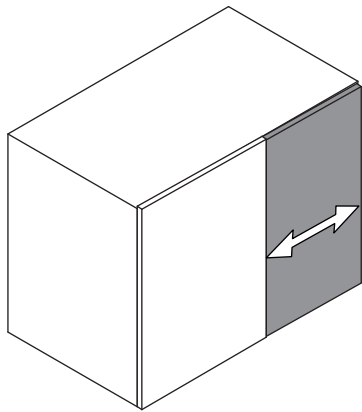
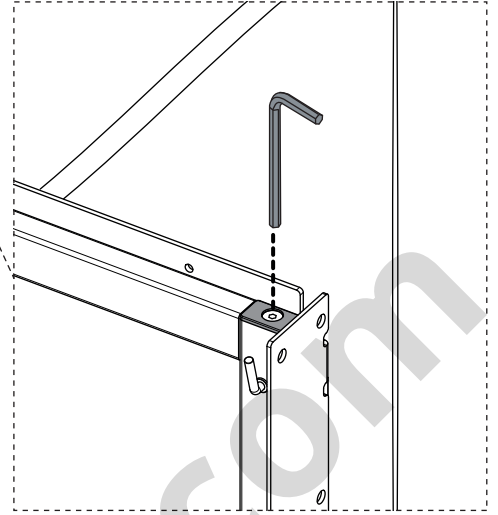
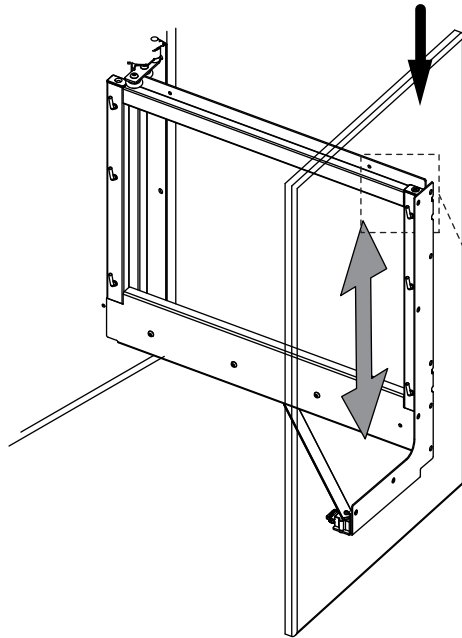
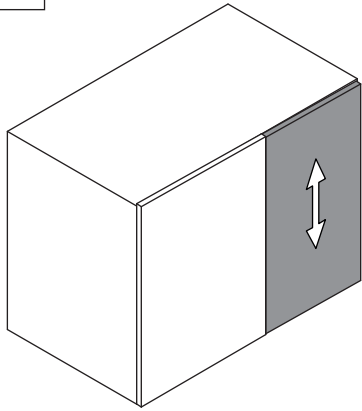



10

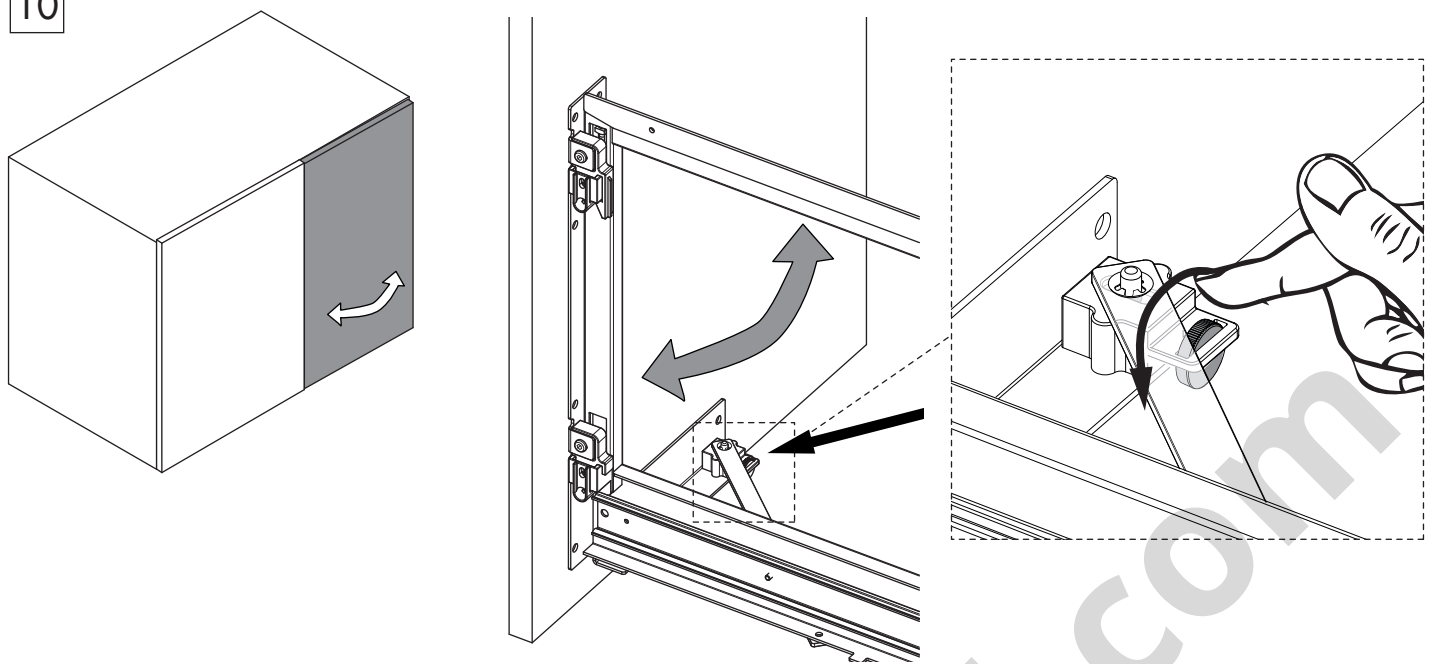

11

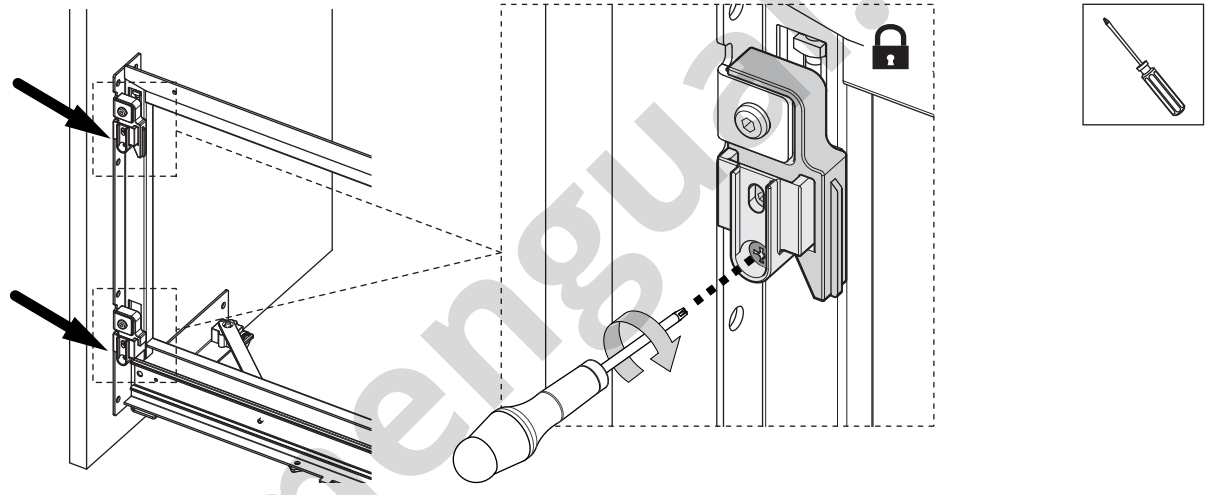

12

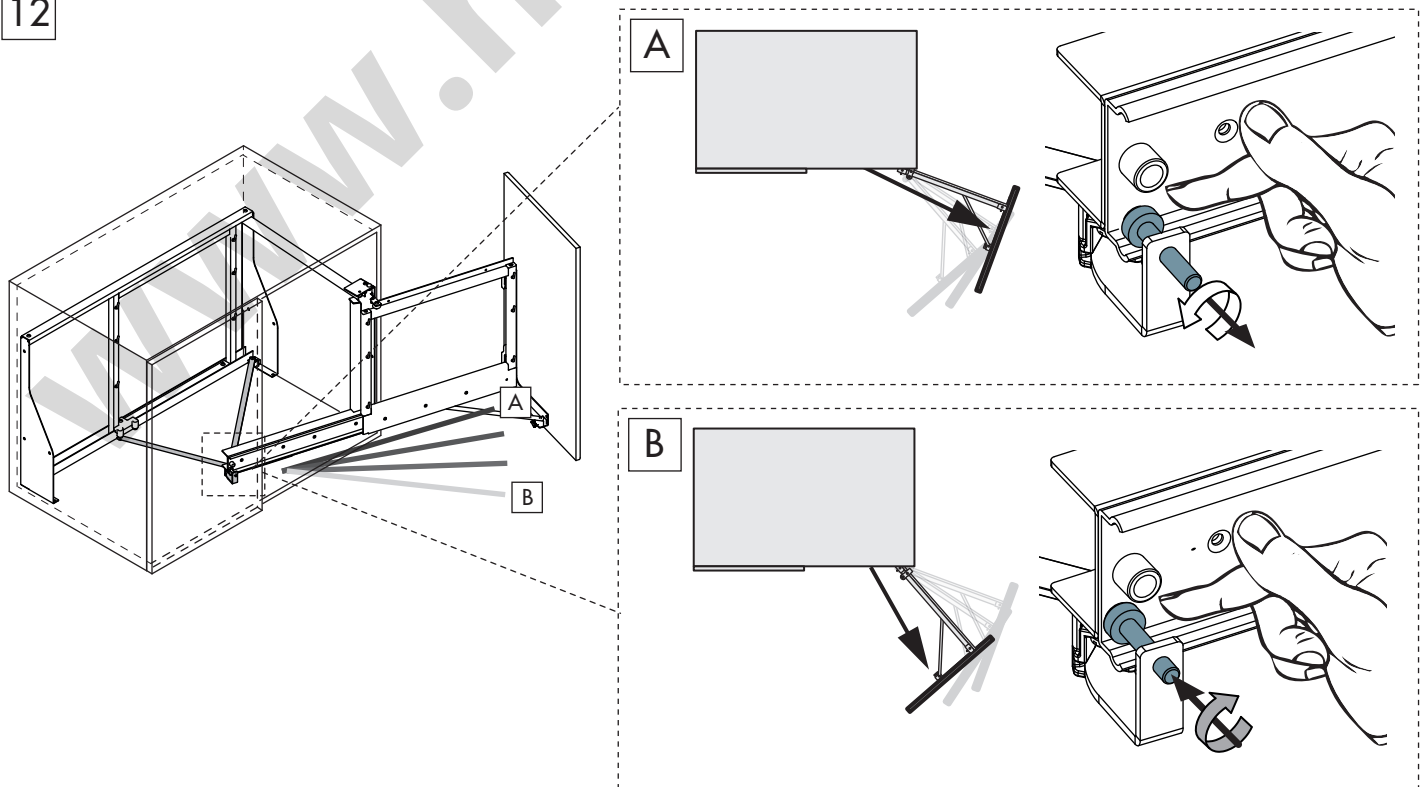

13

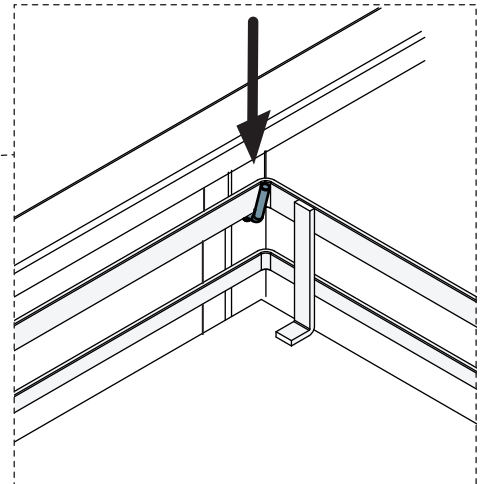
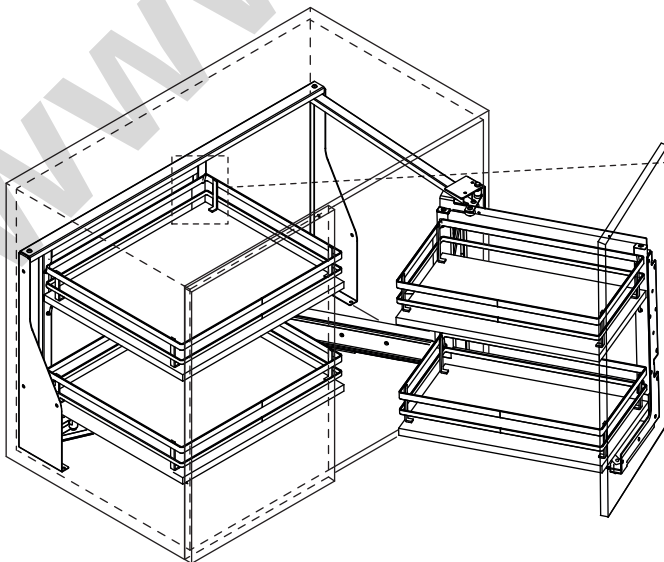
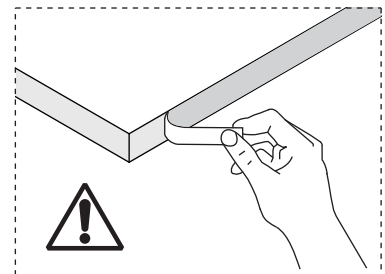
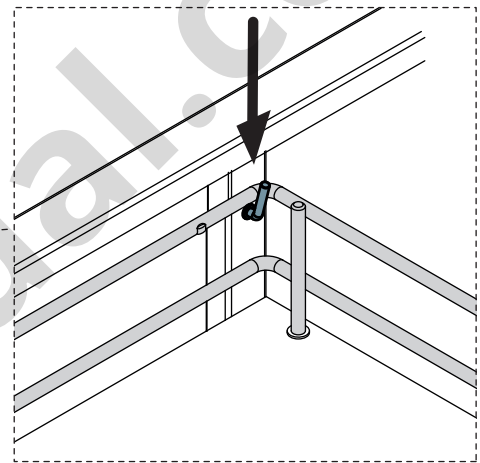
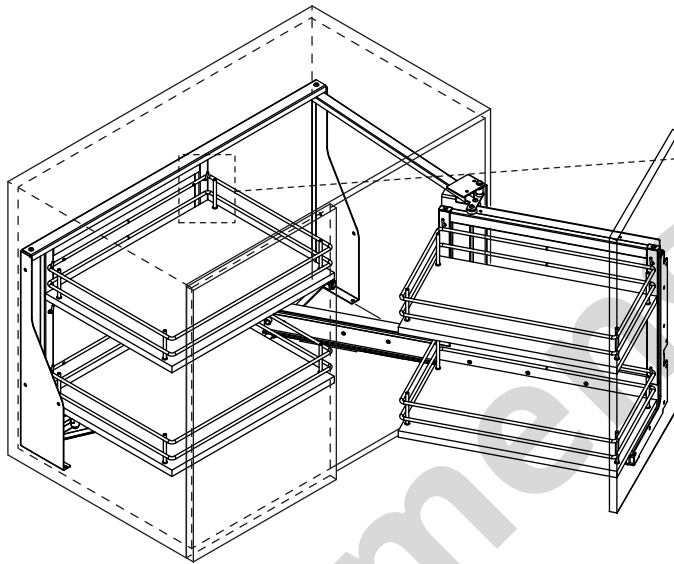
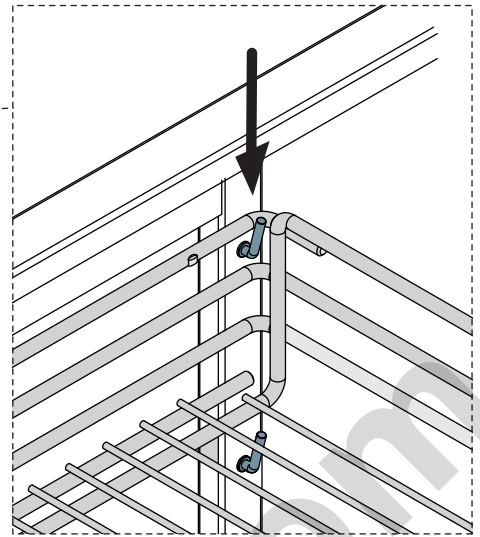
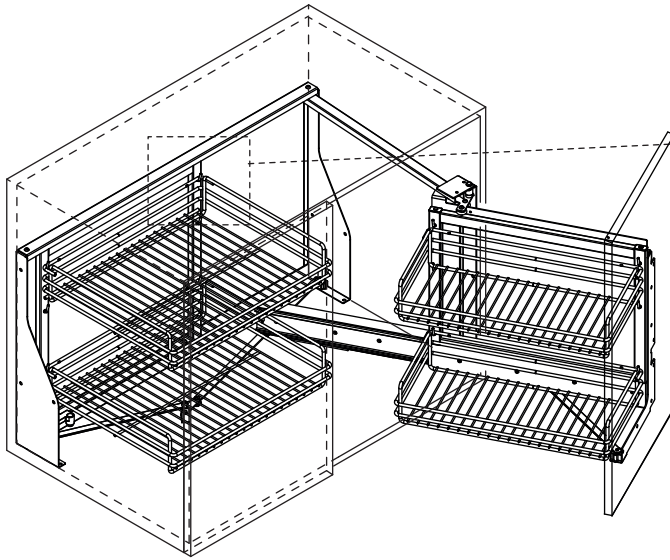



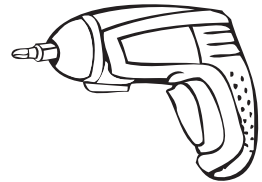
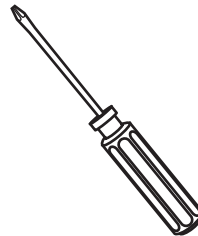
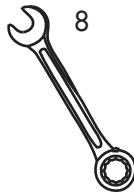
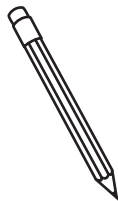
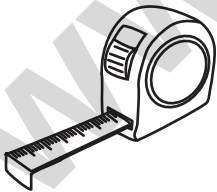
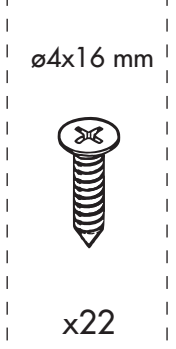
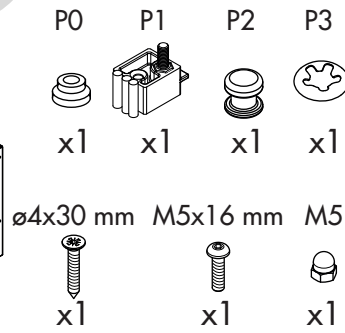
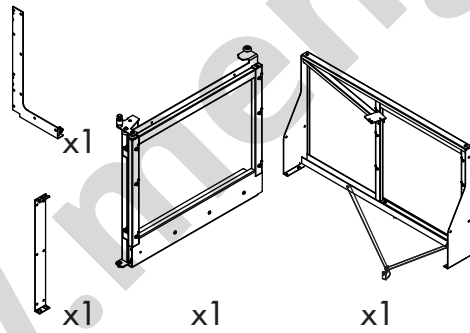
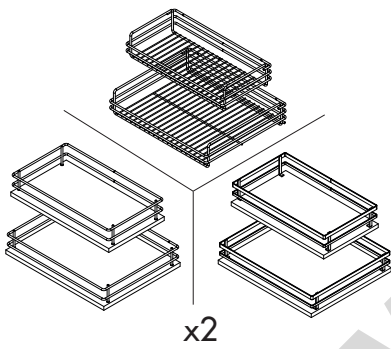
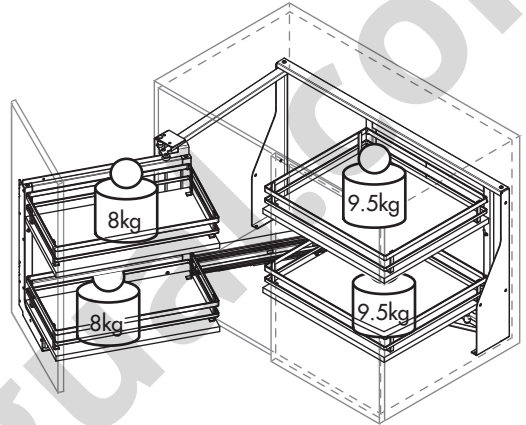
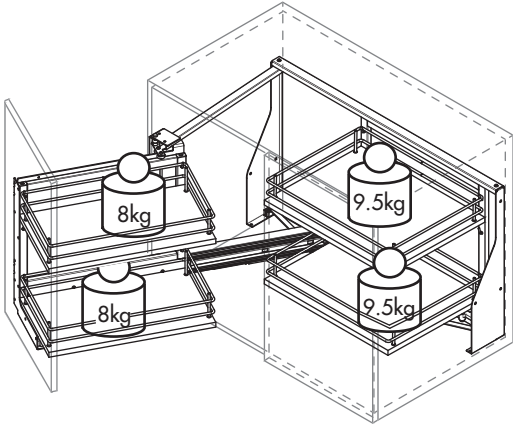
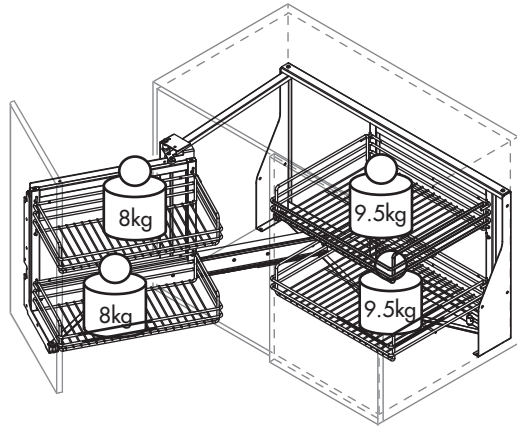

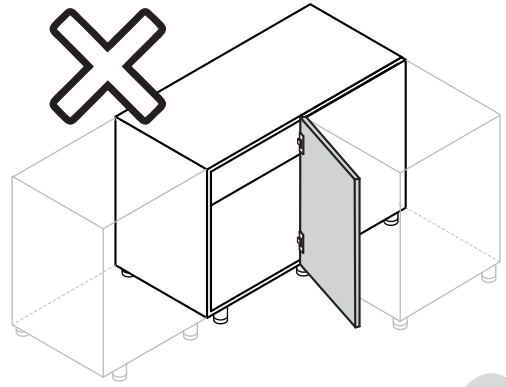
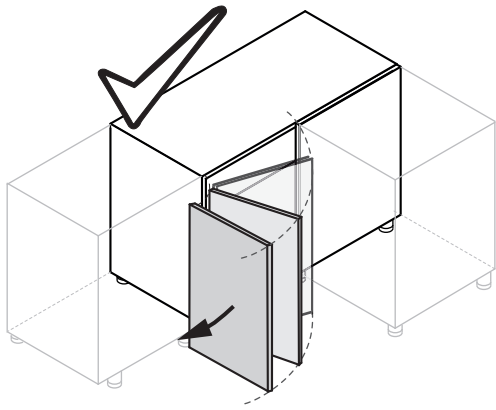

1

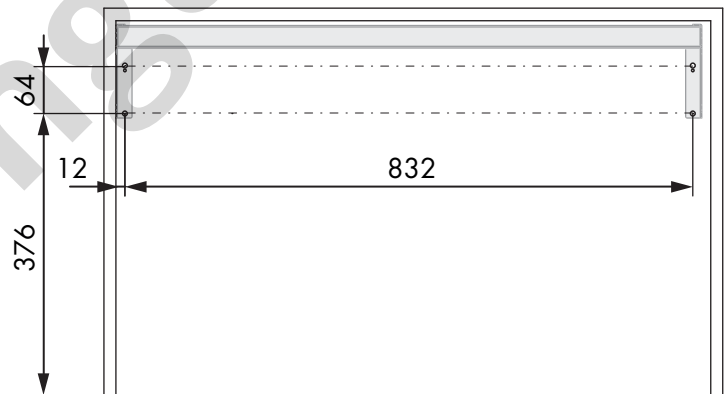
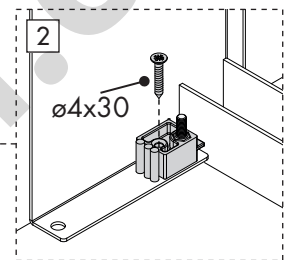
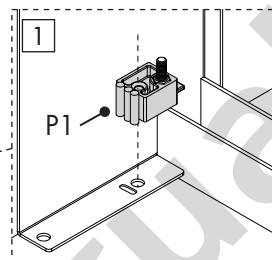
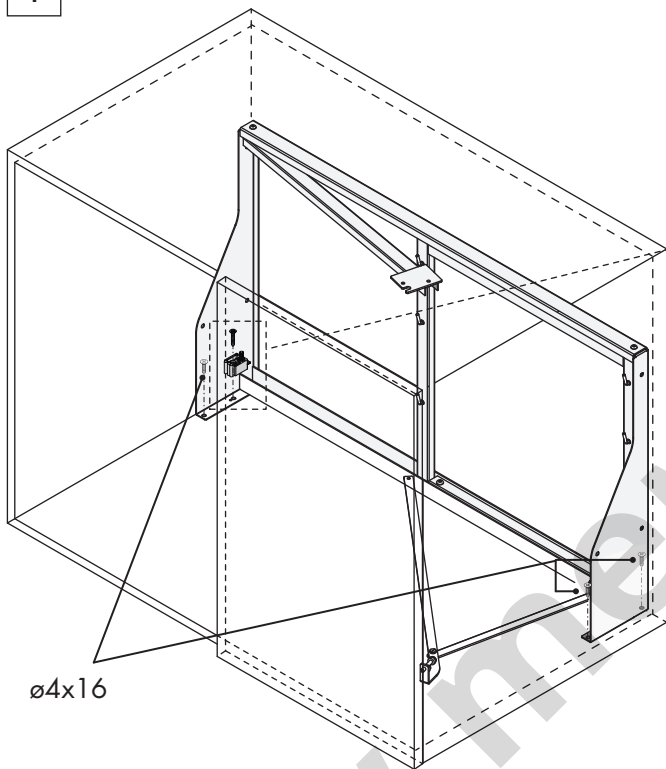
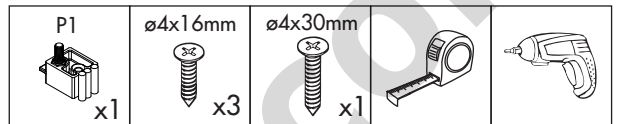

Unidades en milímetros | Units in millimeters | Unités en millimètres

2

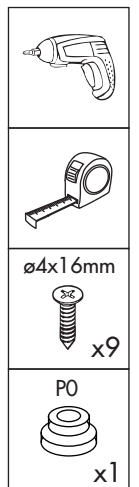
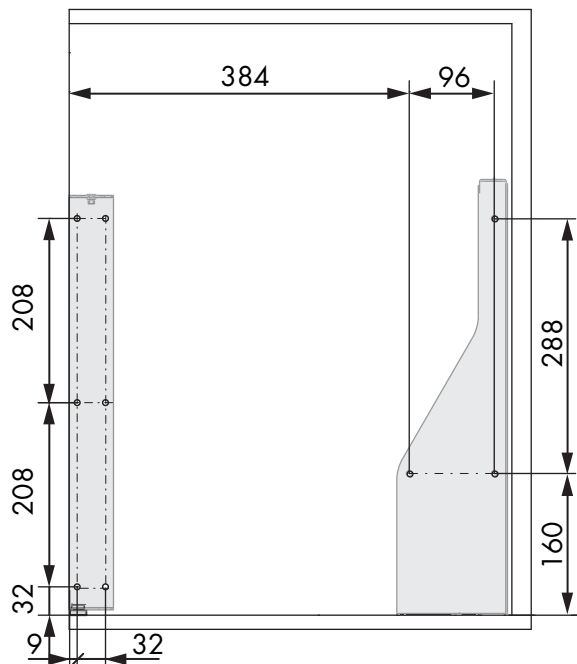
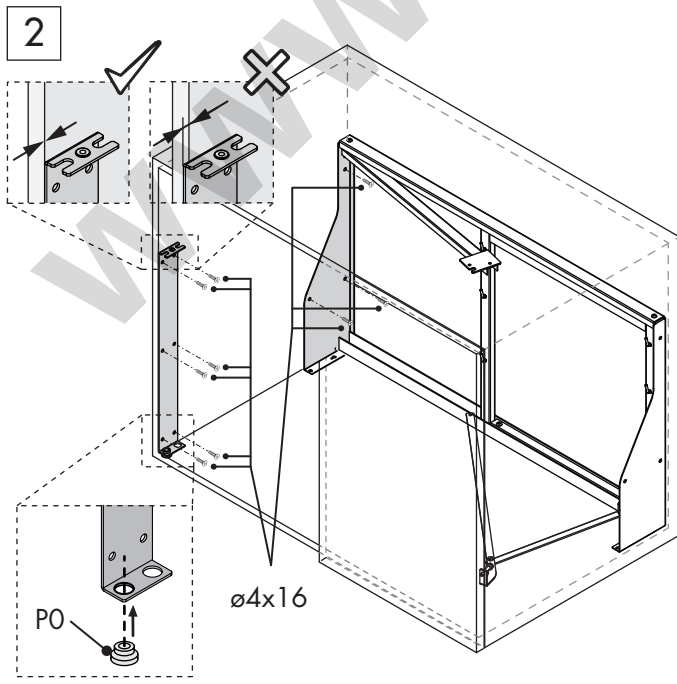

Unidades en milímetros | Units in millimeters | Unités en millimètres

3

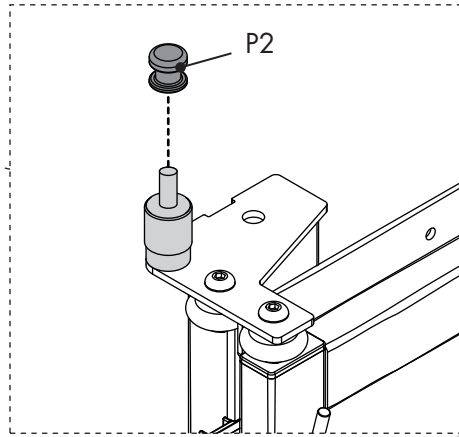
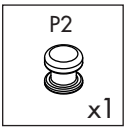
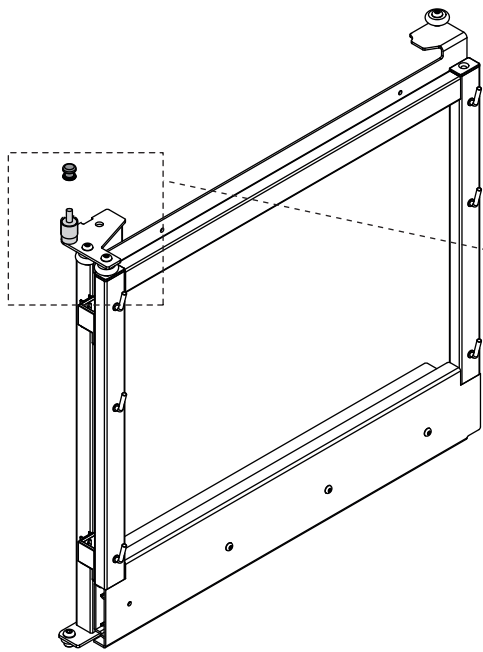

4

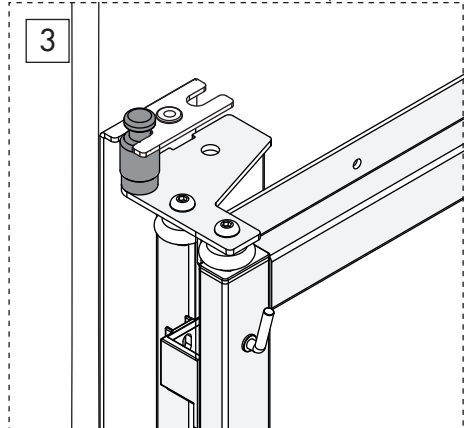
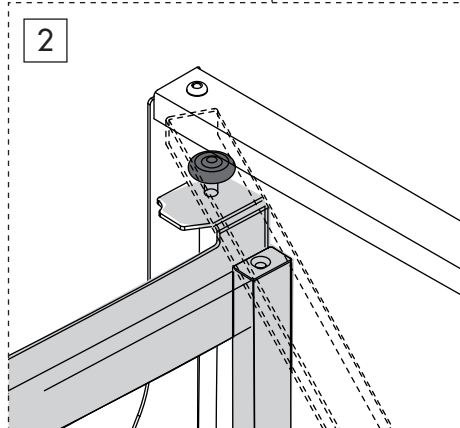
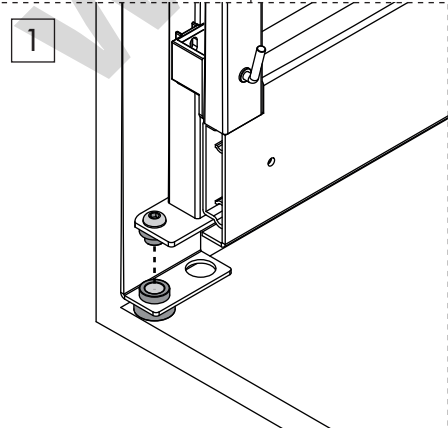
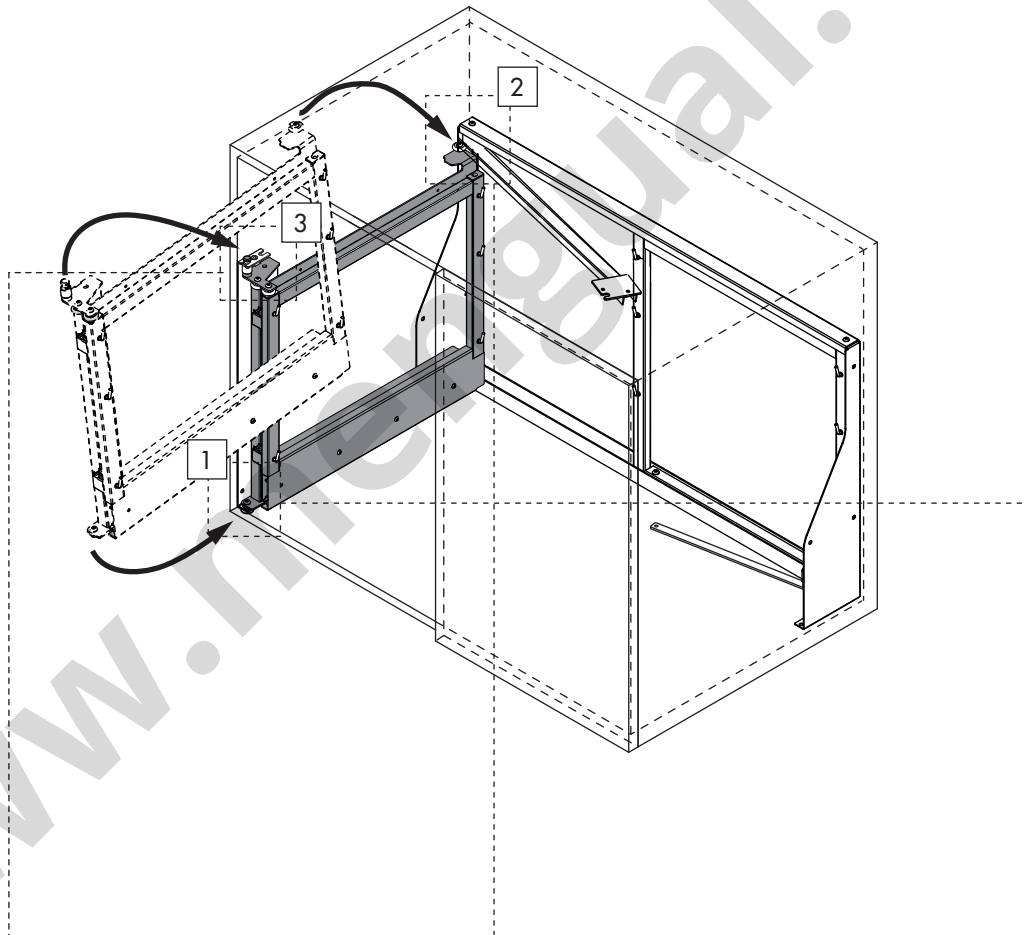

5

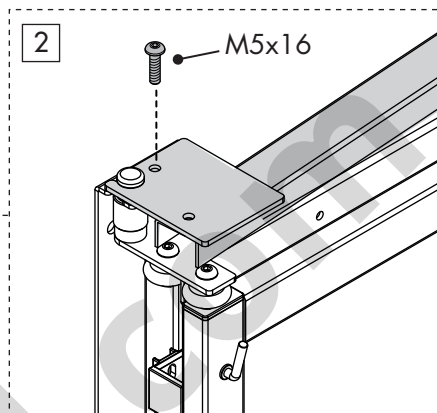
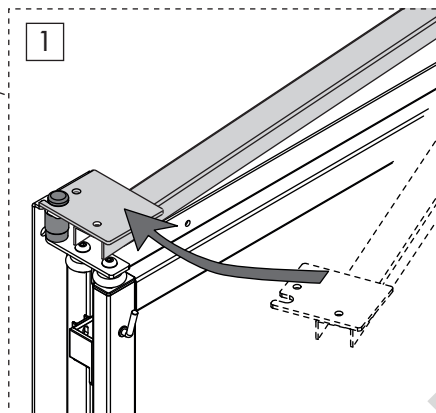
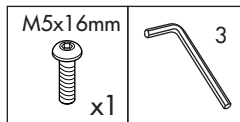
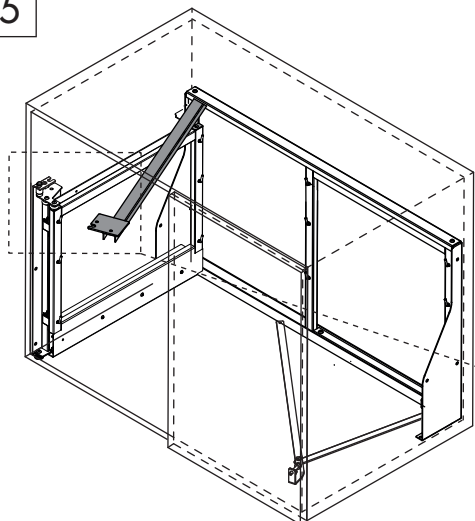

6

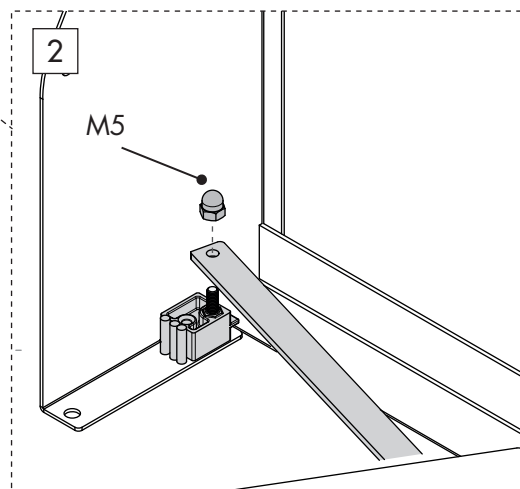
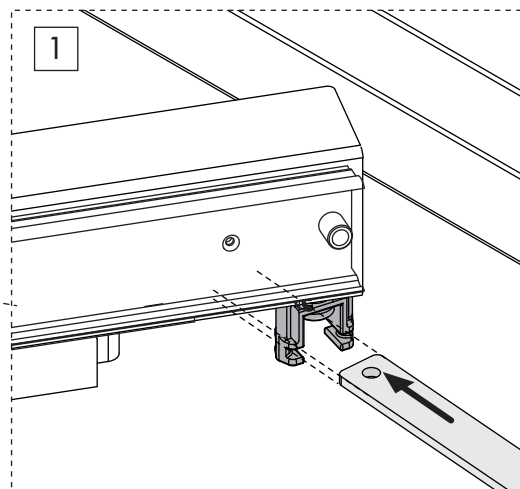
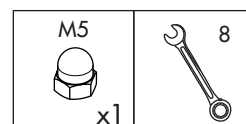
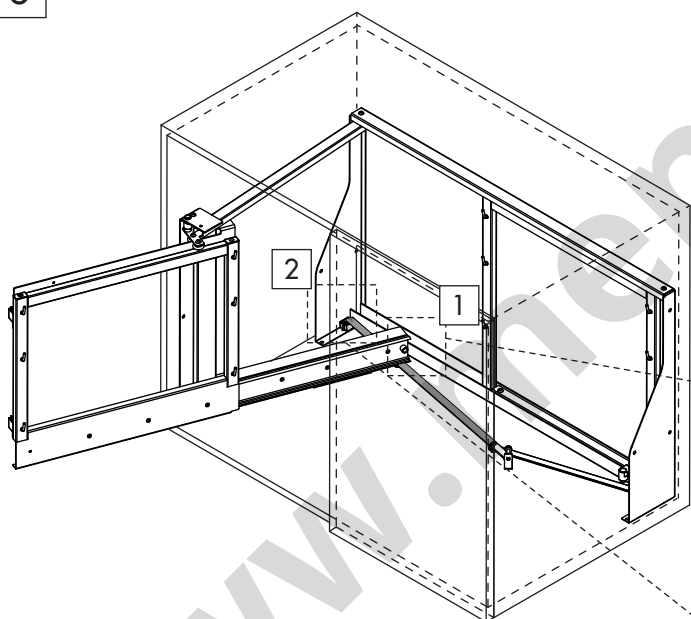

Respetar orden de montaje. No hacerlo puede implicar la rotura de la pieza de plástico (M5).  
 Respect assembly steps order. Not doing so can cause the breaking of the plastic piece (M5).  
 Respecter l'ordre de montage. Ne pas le faire peut provoquer la rupture de la pièce en plastique (M5).

7

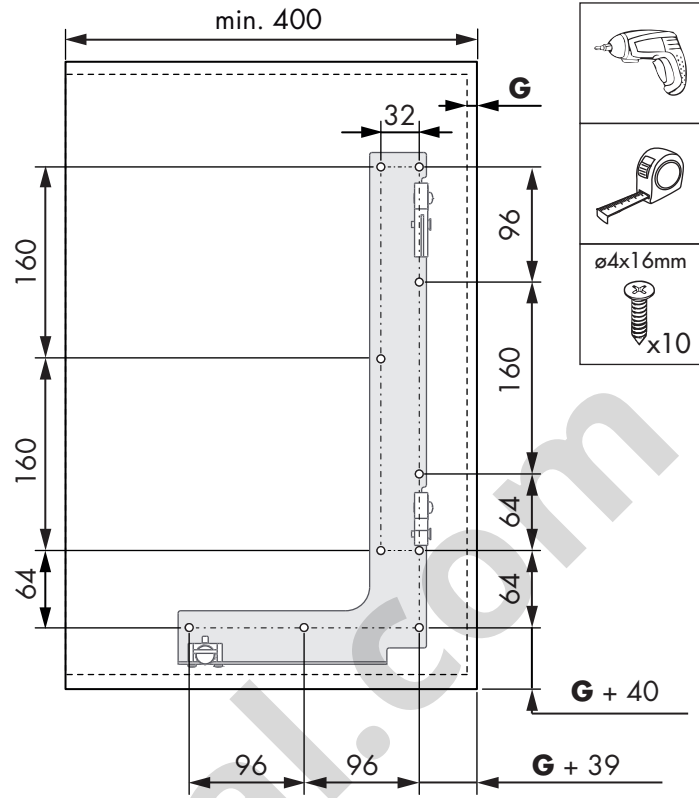
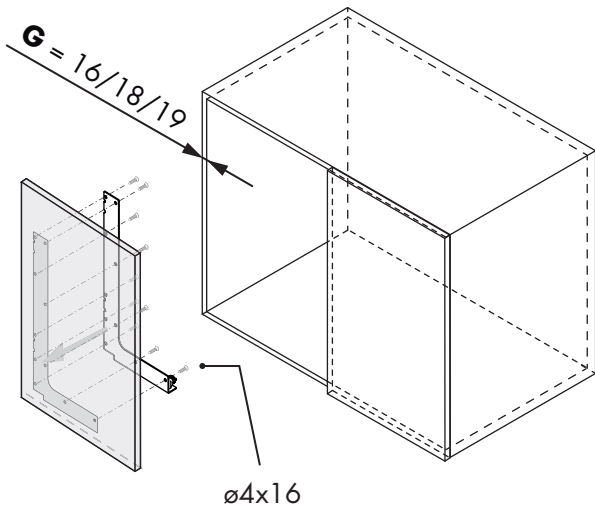

G : Grosor mueble | Cabinet thickness | Grosseur du meuble  
 Unidades en milímetros | Units in millimeters | Unités en millimètres

8

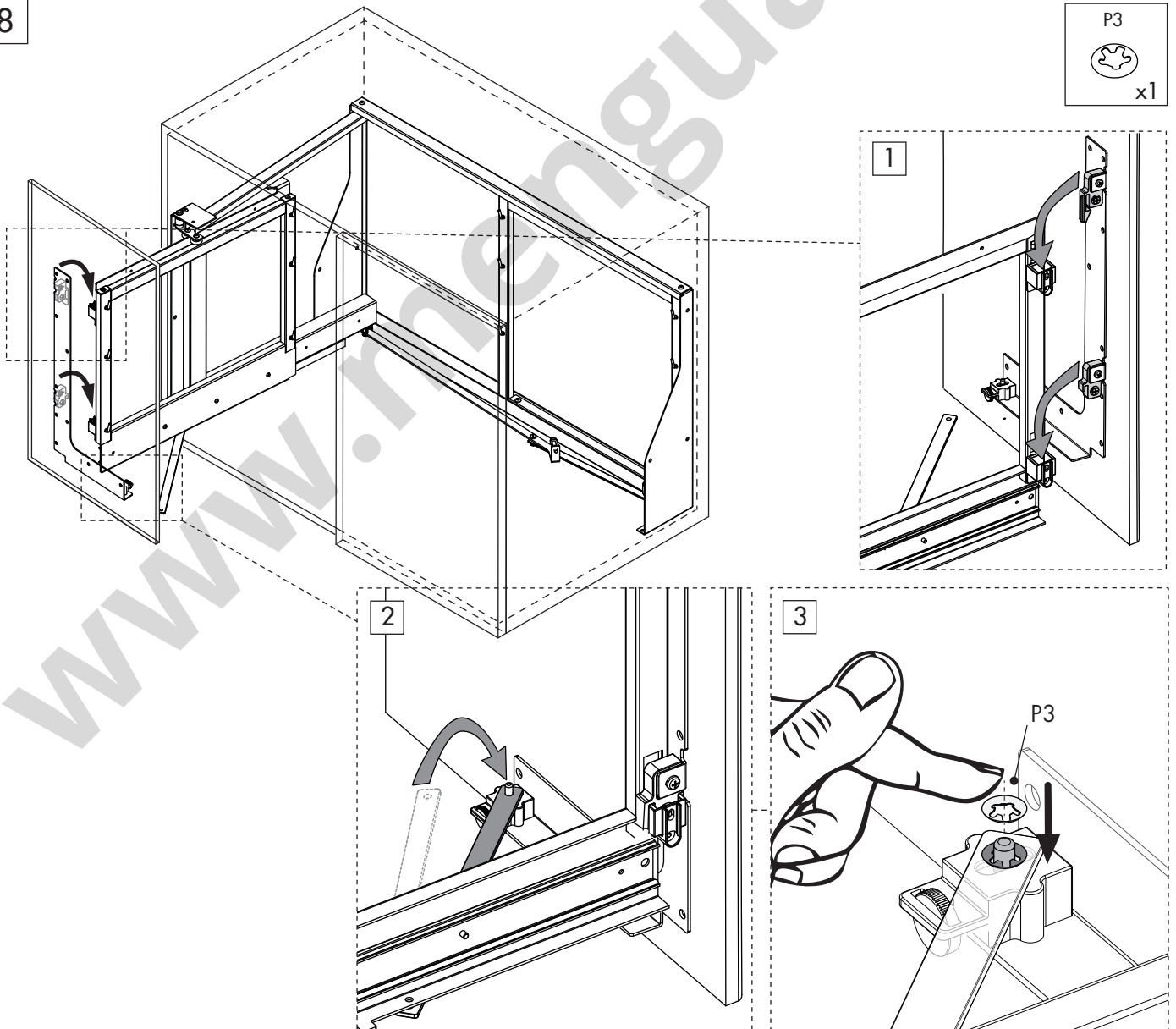

9

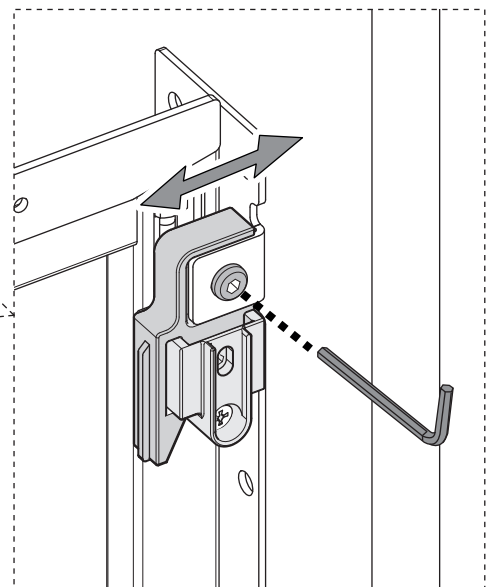
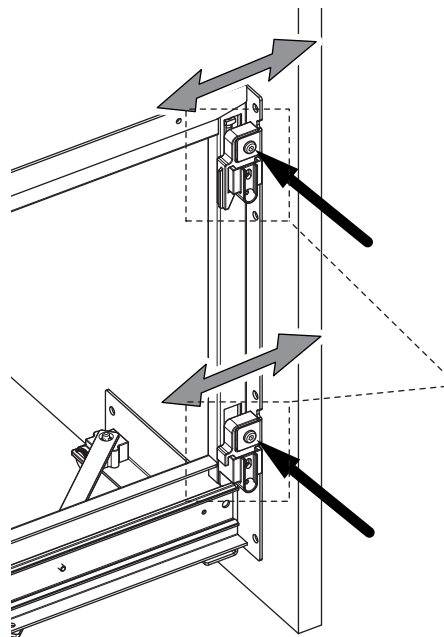
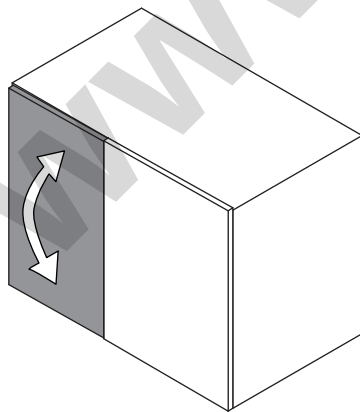
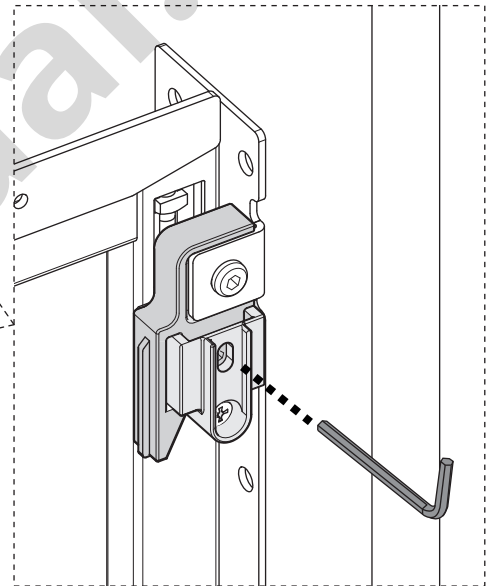
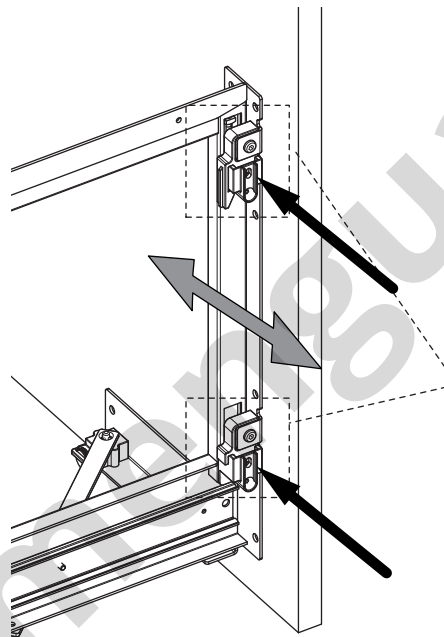
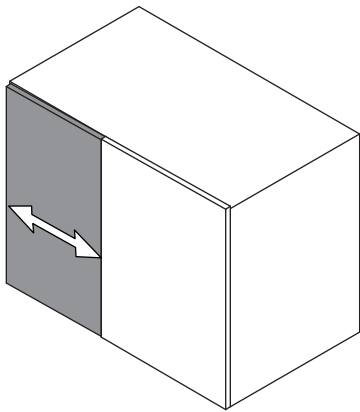
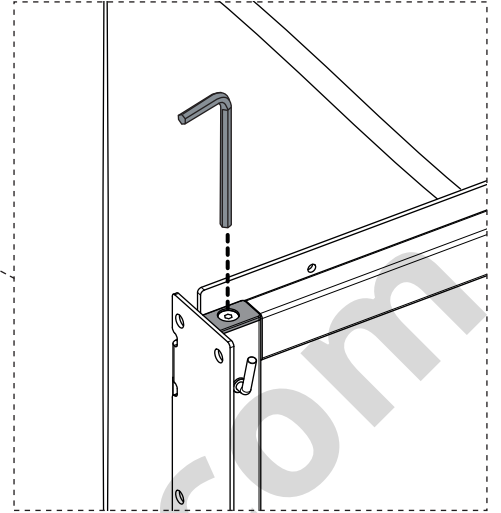
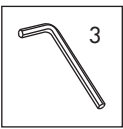
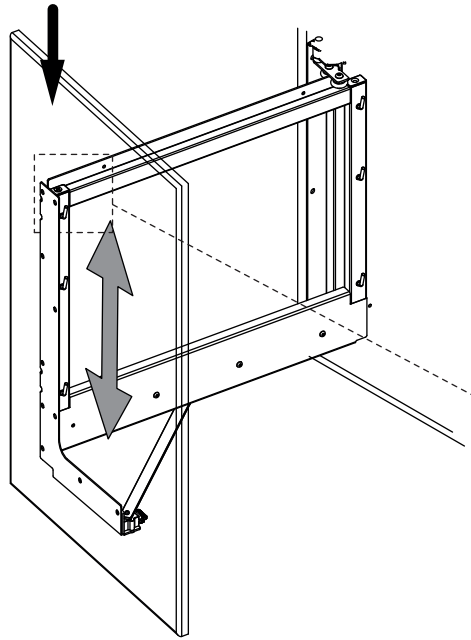
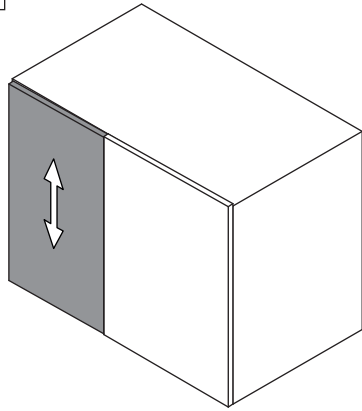



10

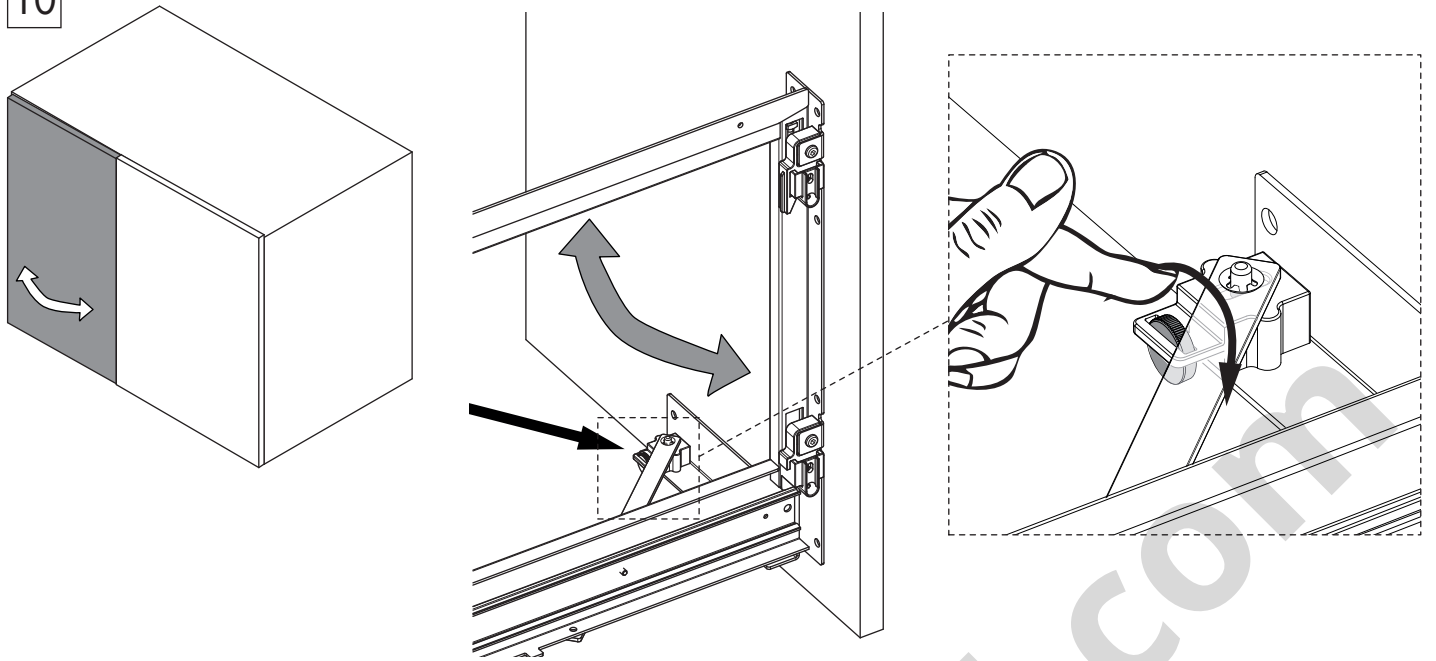

11

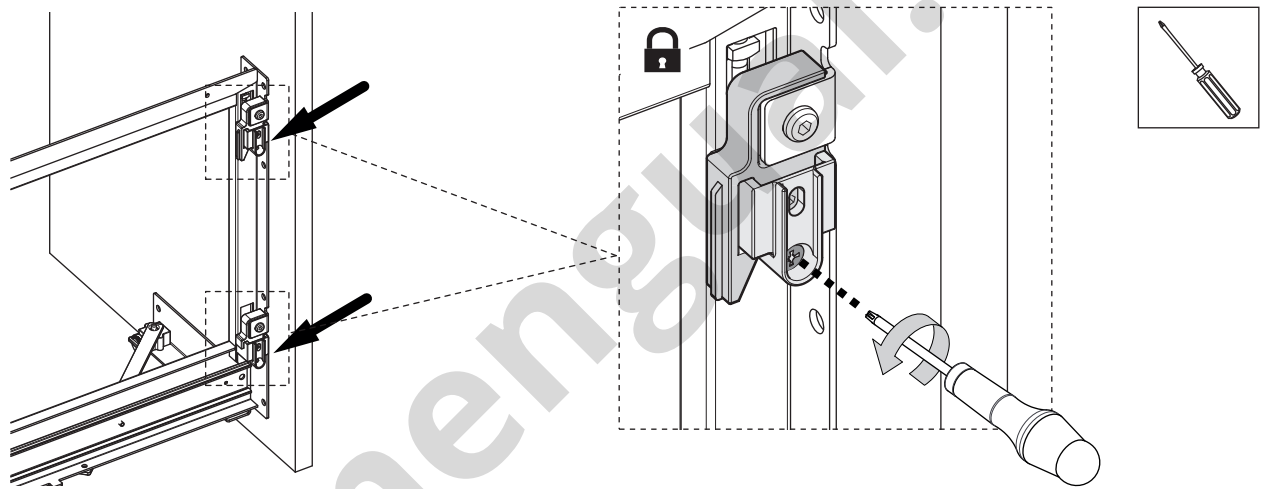

12

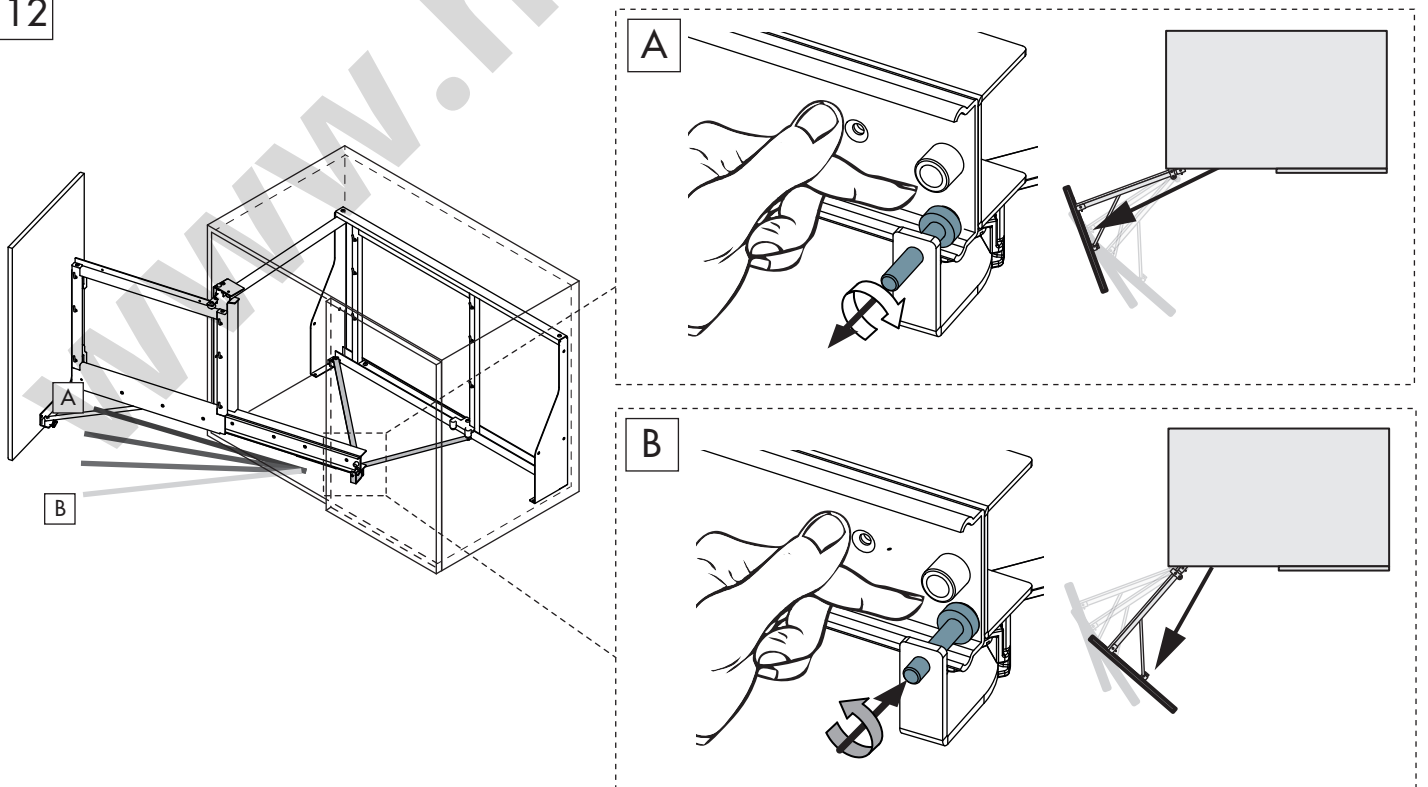

13

