

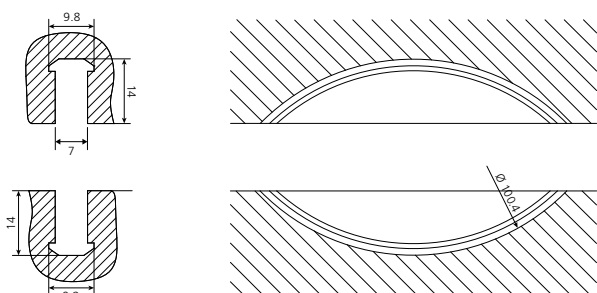

# Tenso P-14

Pat. pend.

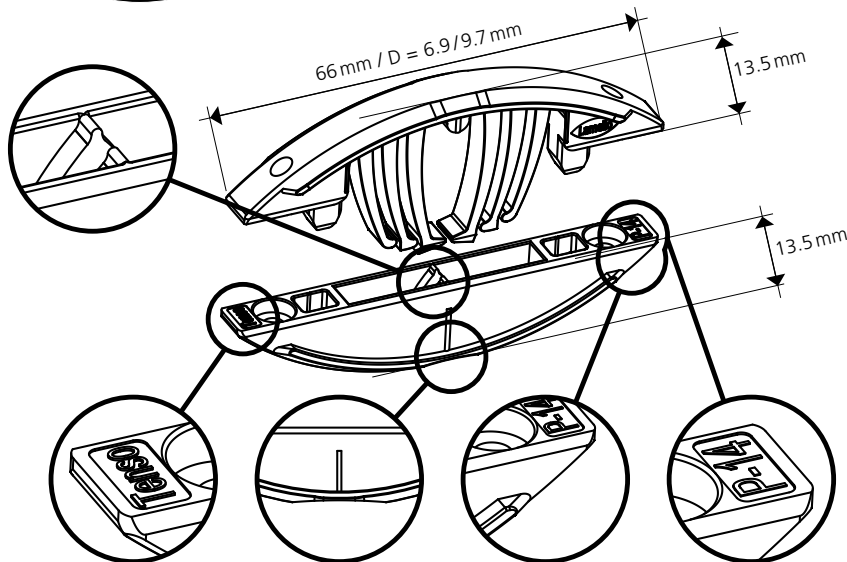
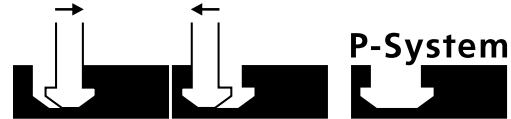

Anzugskraft / Tensile Force: 150 N

Haltekraft / Retention Force: 250 N

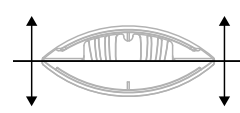
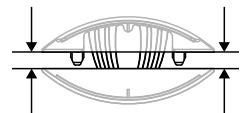

## Immer in Verbindung mit Klebstoff verwenden

zusätzlicher Klebstoff im Verbinder erhöht die Zugbruchfestigkeit um 30%

Hiweis: Probe-verbinden mit Bisco P-14 möglich

## Always use in combination with glue

additional glue in the fitting increases the tensile strength by 30%

Tip: Sample joining with Bisco P-14 possible

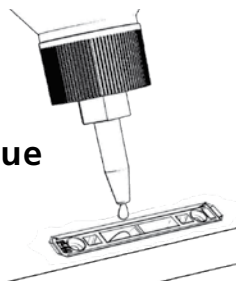

Wichtig: Für eine maximale Spannkraft!  
Important: for maximum clamping force!

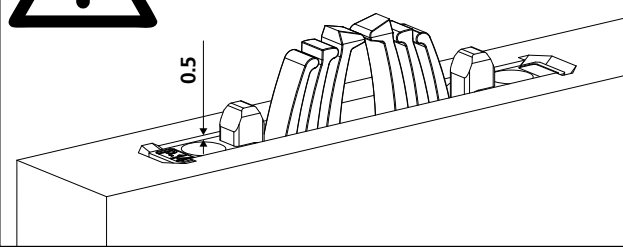

## Zeta P2

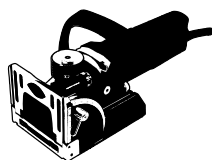

Art.No. 101402



Art.No. 132140 (Diamant)  
DP, Ø 100.4 x 7 x 22 mm



Art.No. 132141  
HW, Ø 100.9 x 7 x 22 mm

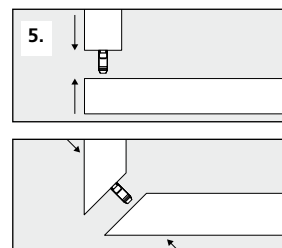
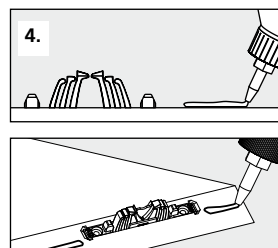
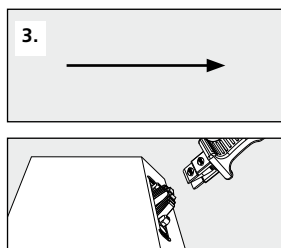
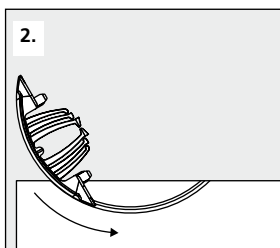
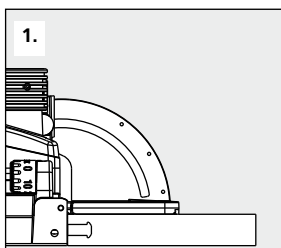
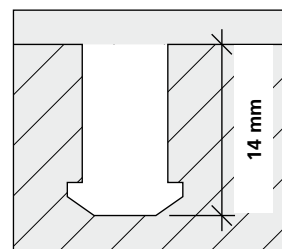
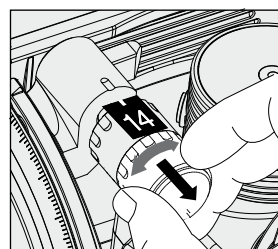

Scharfe Fräser verwenden  
Use sharp cutters

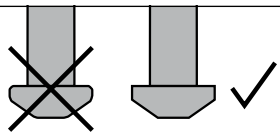

max.  
30 min

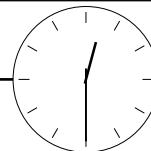

## Anwendungen / applications

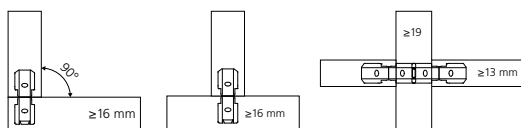

MENGUAL®  
HERRAJES PARA MADERA

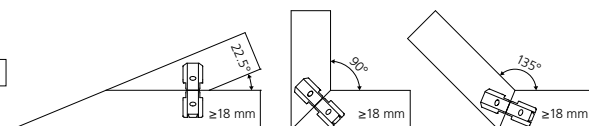
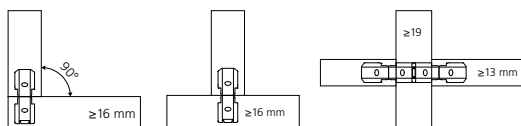
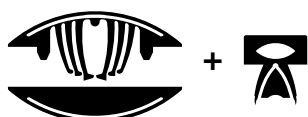

P-10

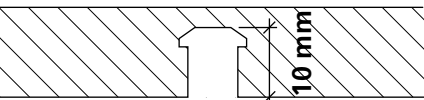

P-18

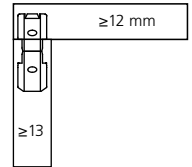
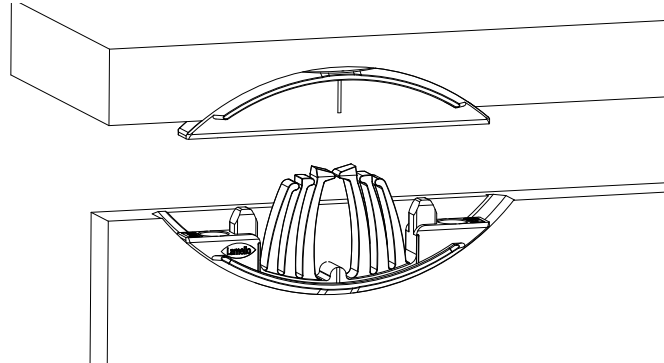
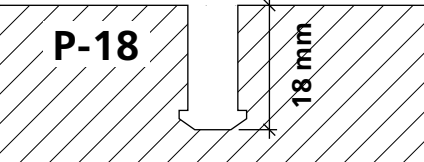

P-18

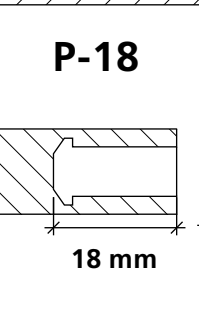

P-10

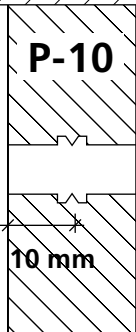

P-18

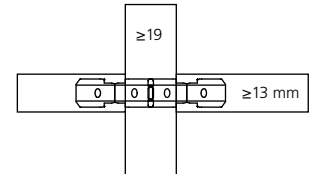
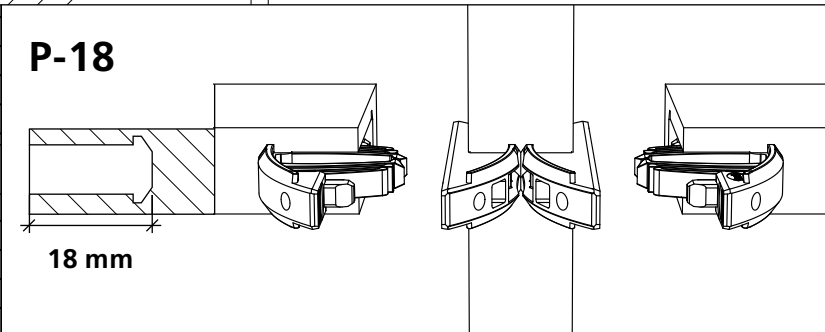

CNC | Partner network: [www.lamello.com](http://www.lamello.com)

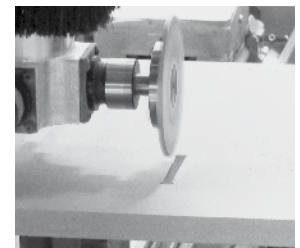
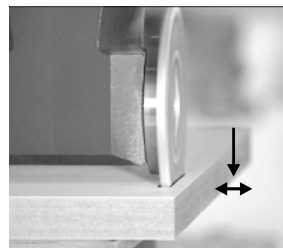
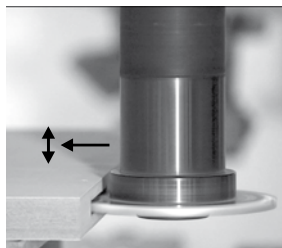
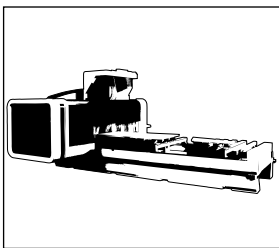

**Art. No. 132142**

DP, 100.4 x 7 x 30 mm  
4 / 6.6 / DTK 48 mm

\* Passend zu allen aufgeführten Fräsdornen  
Suitable for all cutter arbors listed



**Art. No. 132143**

DP, 100.4 x 7 x 40 mm  
4 / 5.5 / DTK 52 mm

**Art. No. 132144**

DP, 100.4 x 7 x 16 mm  
4 / 5.5 / DTK 28 mm

**\* Art. No. 132150**

20 x 50, L = 102 mm

**\* Art. No. 132151**

25 x 60, L = 102 mm

**\* Art. No. 132152**

16 x 50, L = 85 mm

**\* Art. No. 132153**

16 x 55, L = 68 mm

**\* Art. No. 132154**

16 x 50, L = 85 mm, mit Spannfläche (2°-schräg) / with clamping surface (2°- angle)

**\* Art. No. 132155**

20 x 50, L = 85 mm, mit Spannfläche (2°-schräg) / with clamping surface (2°- angle)

