

 **ITALIANA**[®]
f e r r a m e n t a

Kiaro Easy  MENGUAL[®]

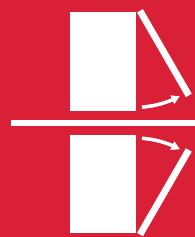

OPENING
SYSTEMS
FOR FLAP
AND DROP
DOWN
DOORS

KIARO EASY





UNHANDED MECHANISM

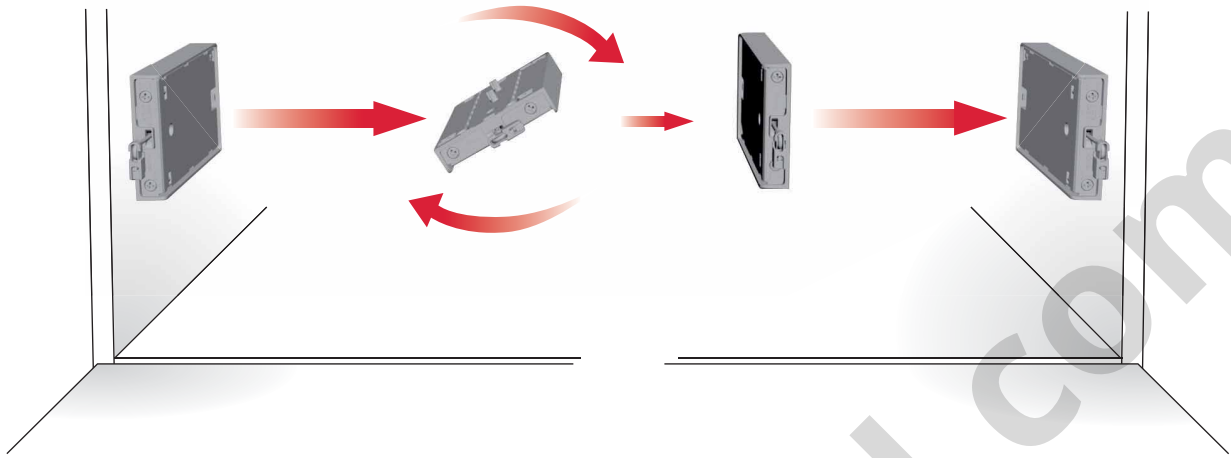

MECHANISM AND DOOR BRACKET INSTALLATION

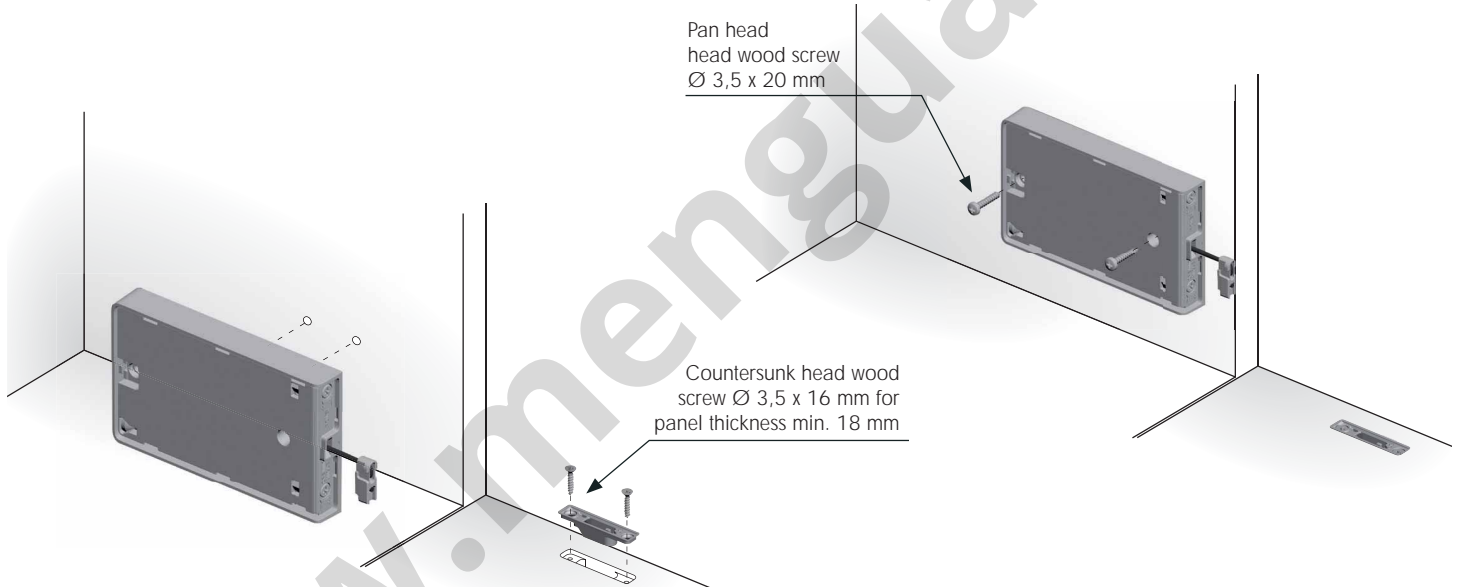

WIRE INSERTION ONTO THE DOOR BRACKET

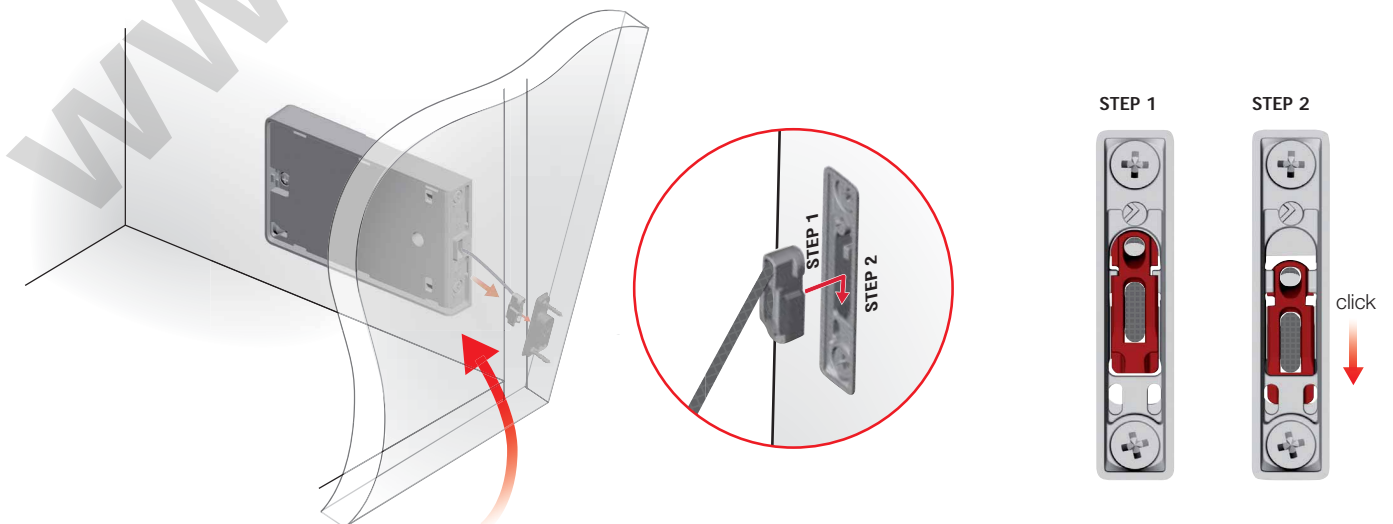

Lift the door almost completely to slot the end element of the wire into the door bracket.

DOOR BRACKET COVER CAP INSERTION

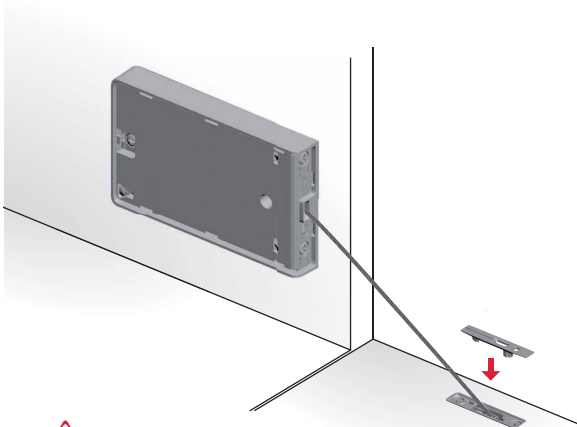

Place the cover cap on the door bracket before lifting the door.

OPENING ANGLE ADJUSTMENT

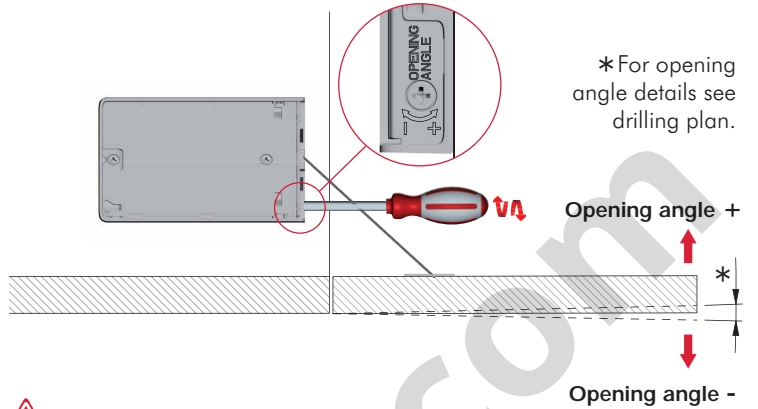

*For opening angle details see drilling plan.



The adjustment of door opening angle must be carried out before the power adjustment.

POWER ADJUSTMENT

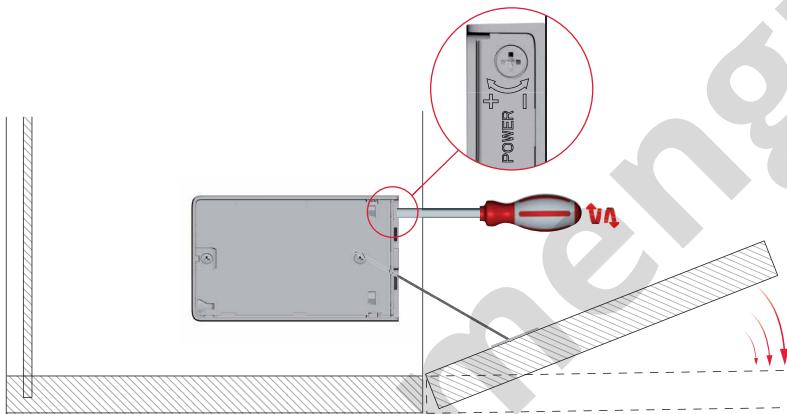

Power +
The slowing phase of door opening is anticipated.

Power -
The slowing phase of door opening is delayed.

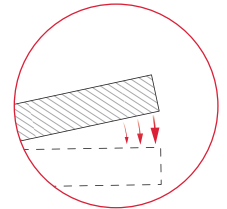
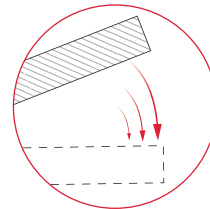

COVER CAP INSERTION FOR ADJUSTMENT SLOT

STEP 1

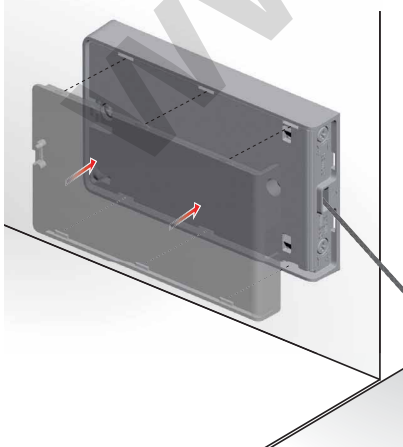

STEP 2

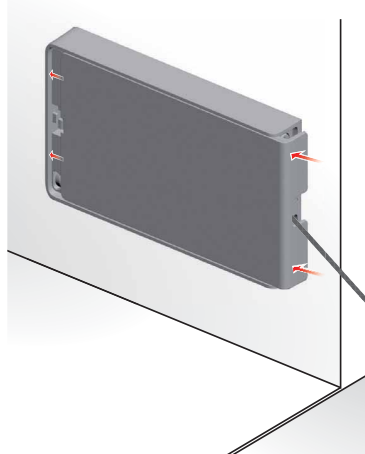

SPOTS FOR COVER REMOVAL

Use a blade screwdriver to unlock the cover and proceed with showed removal steps.

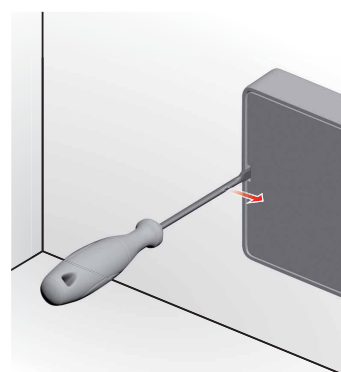

REMOVAL STEP 1

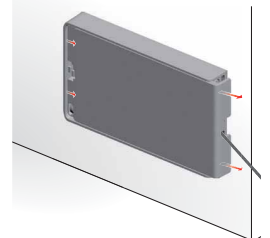

REMOVAL STEP 2

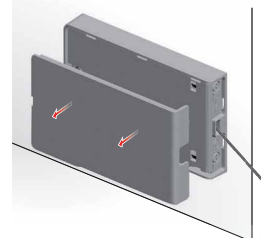

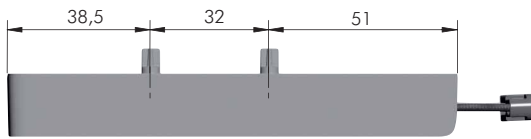
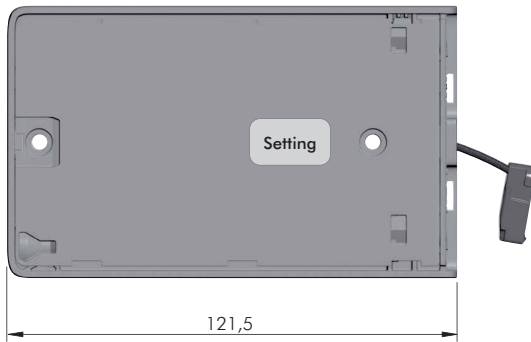
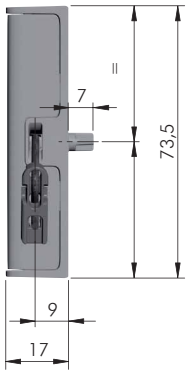

ZA	EP	ST	= 20 pcs.
49504000EE	EW	Soft	
49506000EE	EW	Strong	

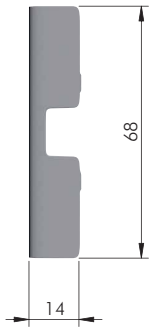

EP	= 20 pcs.
49502000EE	EW



www.mengli.com

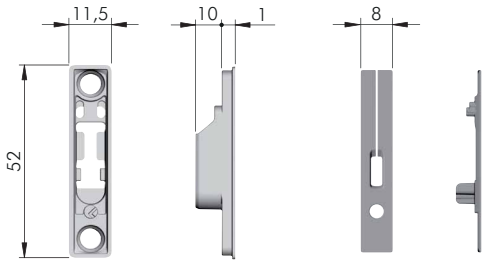

ZA	EP	= 20 pcs.
49503000YQ	YA	

DOOR PANEL DRILLING OPERATIONS

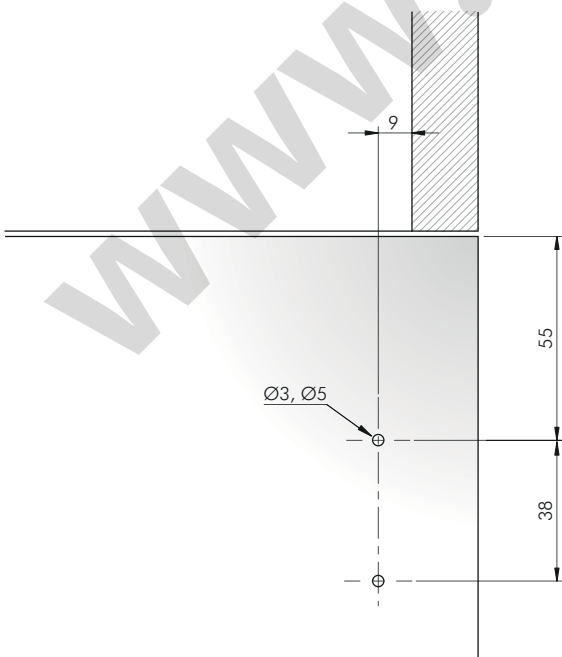
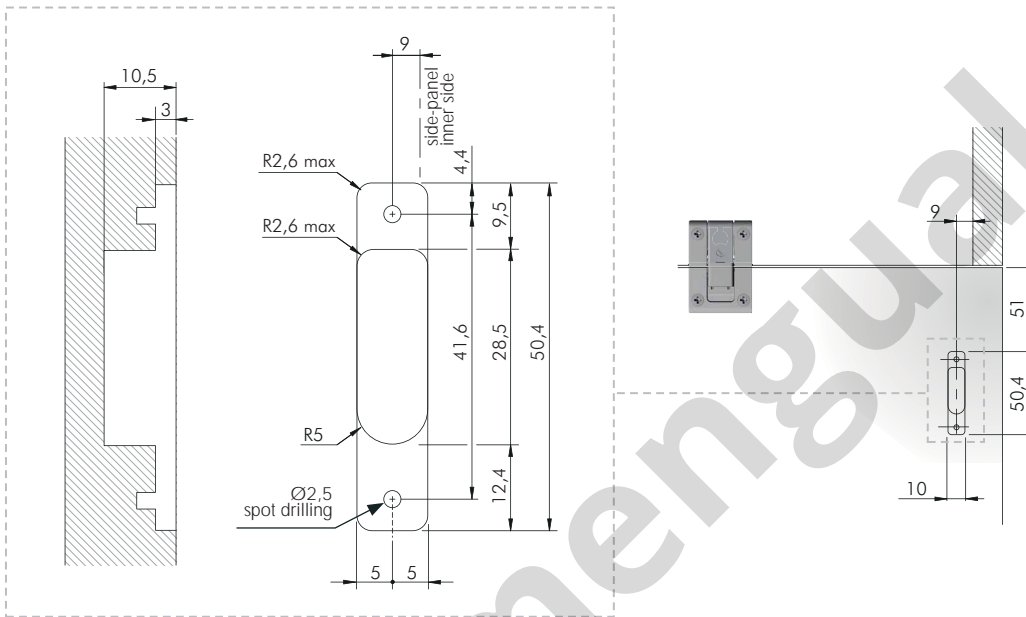

ZA	EP	= 20 pcs.
49503500YQ	YA	

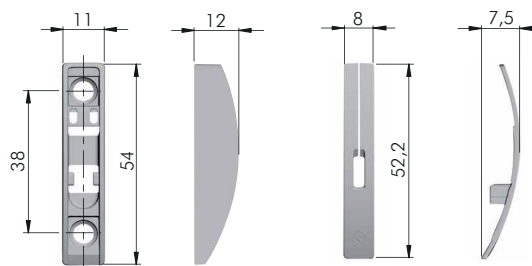



KIARO EASY WITH KIMANA HINGE



SIDE PANEL DRILLING PLAN

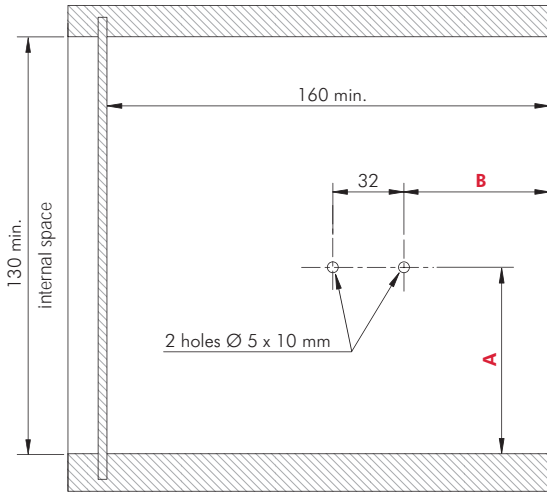

Drilling plan	A	B
Embedded door bracket	90	85
Screw fixing door bracket	90	93



Overcrossing 90° door opening angle, negatively affects the Kimana hinges.



In case of door without handles it is recommended to use **K Push Tech with buffer**.

KIARO EASY WITH STANDARD UNSPRUNG HINGES



In case other hinges than KIMANA are used, it is necessary to contact an authorized dealer for a correct drilling scheme.



ACCESSORY FOR MECHANISM FIXING

- = Ø 3 mm
- = PZ2
- = 10.000 pcs.

60103160ZN

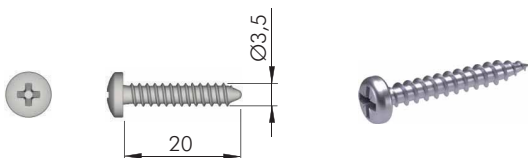

ACCESSORY FOR DOOR BRACKET FIXING

- = Ø 3 mm
- = PZ2
- = 10.000 pcs.

60101390ZN

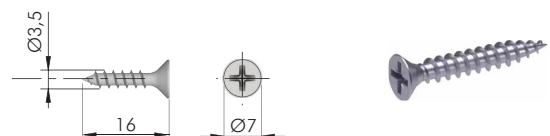

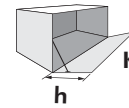

Kg = Door weight including the possible handle.

SINGLE INSTALLATION

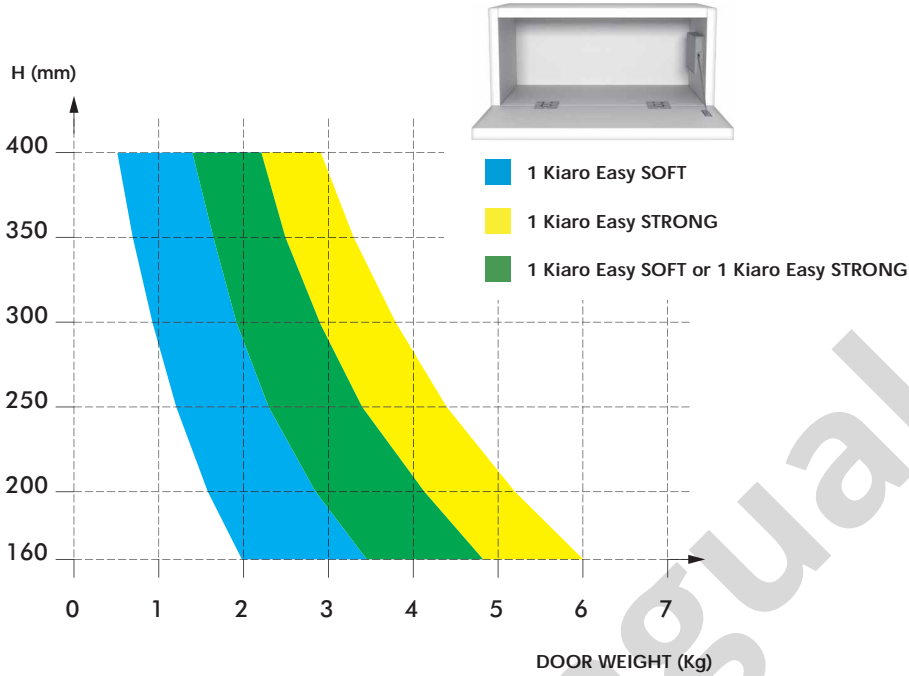

DOUBLE INSTALLATION

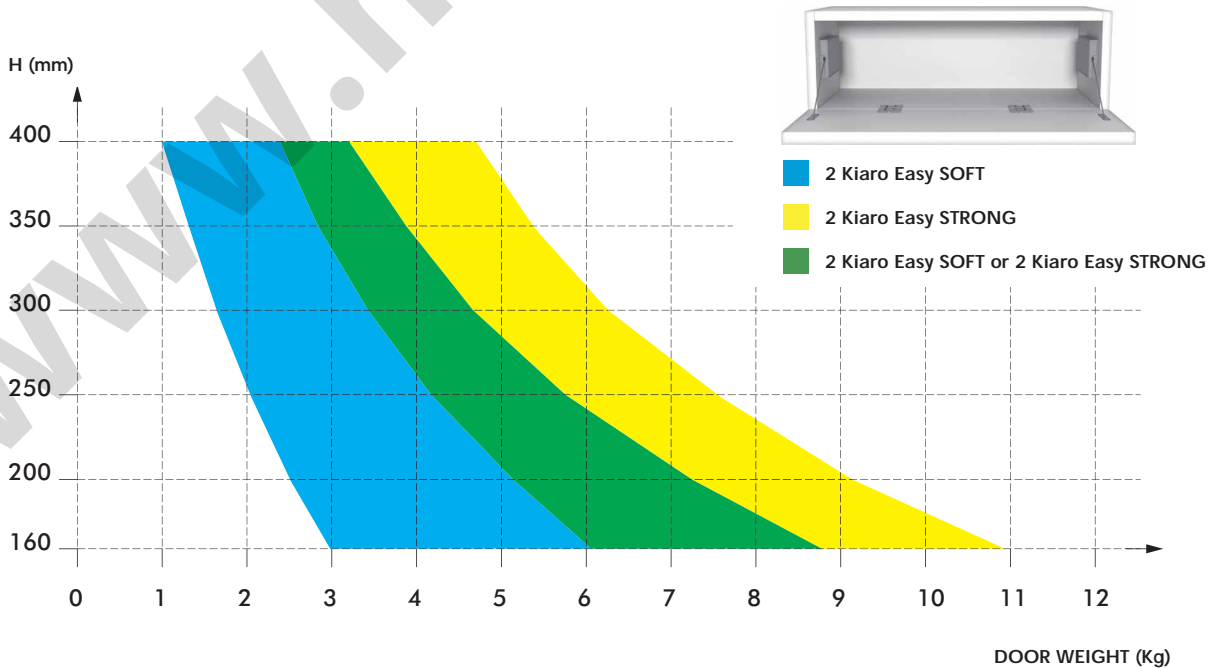



Preview KIARO EASY chart

Standard chipboard
650 Kg/m³

Door dimension			Theoretical weight	
H	L	Sp.		
200	450	18	1,05 Kg	1pc EASY DA 150*
200	600	18	1,40 Kg	1pc EASY DA 150*
200	900	18	2,11 Kg	1pc EASY DA 150
200	1200	18	2,81 Kg	1pc EASY DA 150
250	450	18	1,32 Kg	1pc EASY DA 150
250	600	18	1,76 Kg	1pc EASY DA 150
250	900	18	2,63 Kg	2pcs EASY DA 150
250	1200	18	3,51 Kg	2pcs EASY DA 150
300	450	18	1,58 Kg	1pc EASY DA 150
300	600	18	2,11 Kg	1pc EASY DA 150
300	900	18	3,16 Kg	2pcs EASY DA 150
300	1200	18	4,21 Kg	2pcs EASY DA 350
350	450	18	1,84 Kg	1pc EASY DA 150
350	600	18	2,46 Kg	1pc EASY DA 350
350	900	18	3,69 Kg	2pcs EASY DA 350
350	1200	18	4,91 Kg	2pcs EASY DA 350
400	450	18	2,11 Kg	1pc EASY DA 350
400	600	18	2,81 Kg	1pc EASY DA 350
400	900	18	4,21 Kg	2pcs EASY DA 350
400	1200	18	5,62 Kg	2pcs EASY DA 350

* Applicable with special drilling plan

MDF panel
780 Kg/m³

Door dimension			Theoretical weight	
H	L	Sp.		
200	600	18	1,68 Kg	1pc EASY DA 150
200	900	18	2,53 Kg	1pc EASY DA 150
200	1200	18	3,37 Kg	1pc EASY DA 150
250	450	18	1,58 Kg	1pc EASY DA 150
250	600	18	2,11 Kg	1pc EASY DA 150
250	900	18	3,16 Kg	2pcs EASY DA 150
250	1200	18	4,21 Kg	2pcs EASY DA 150
300	450	18	1,90 Kg	1pc EASY DA 150
300	600	18	2,53 Kg	1pc EASY DA 150
300	900	18	3,79 Kg	2pcs EASY DA 150
300	1200	18	5,05 Kg	2pcs EASY DA 350
350	450	18	2,21 Kg	1pc EASY DA 150
350	600	18	2,95 Kg	1pc EASY DA 350
350	900	18	4,42 Kg	2pcs EASY DA 350
350	1200	18	5,90 Kg	2pcs EASY DA 350
400	450	18	2,53 Kg	1pc EASY DA 350
400	600	18	3,37 Kg	2pc EASY DA 350
400	900	18	5,05 Kg	2pcs EASY DA 350
400	1200	18	6,74 Kg	NOT APPLICABLE